

Locus L182110	Dor 1997	Fld 9C	Sq AH33	Loc. type FLOOR MAKEUP
Open 09/07/97	Date	High at 15.27 N	Low at 15.24 S	Seals: L182112 L182113
Close 10/07/97		15.20 S	15.17 N	Sealed by:
Floor: type		15.10 S	15.19 S	Loci 92311 92901
Length 2.95	Width 2.4	Vol		above
Value S	Remove 10/07/97	Drawn? YES		below
Photo # (1)		Photo # (2)		Loci L182112 L182113
Written by: MAS		Checked by: JRZ		below

Unit	Phase	Stage	Stratum	PoM
-------------	--------------	--------------	----------------	------------

Summary

Opened: IN ORDER TO GO BELOW F9231.

Limits (N) BALK

(S) W9282(b) AND W9290

(E) W18206 AND L18202

(W) L18201

Closed: WENT THROUGH L18210 AND HIT SOIL.

Matrix: CONCRETE WITH A LITTLE POTTERY AND SOME GLASS FRAGMENTS ABOVE A RUBBLE BASE of approximately fist-size cobbles.

Relations: LOCI ABOVE: L9231 COVERS L18210. F9231 SEALS L18210

N: L18210 CONTINUES INTO THE BALK.

E: L18210 IS CUT BY L18202 AND MOST LIKELY REACHES W18206 WHICH WAS ROBBED BY L18202.

S: L18210 REACHES W9282(b). L18210 CONTINUES UNDER W9290, reaching W9282(b) again

W: L18210 IS CUT BY L18201 but probably originally reached W9253.

LOCI BELOW: L18210 COVERS L18212 AND L18213 and seals both of them.

Additional Observations/Value: HIGH VALUE ROMAN FLOOR MAKE UP.

Locus

L 182110

Sketch plan

▨ = L18210 ▩ = L9231
- - - = L18212
~ ~ ~ = L18213

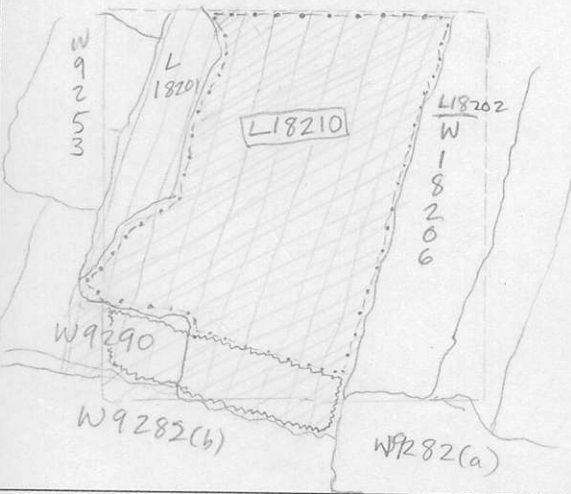

Photo

Photo

Section

Section

