

Locus LJ L18203	Dor 1977	Fld G _L	Sq AG34	Loc. type unsealed G11 ROBBER TRENCH
Open Date 0.8/07/97	High at 1.5.27	NIC	Low at 1.5.23	Seals: _____
Close Date 1.7/07/97	1.4.75	NW	1.4.69	Sealed by: _____
Floor: type _____	Length 0.8	Width 1.0	Vol _____	Loci above 9428 _____
Value W	Remove _____	Drawn? YES		Loci below 18238* _____
Photo #(1) SEE L9428	Photo #(2) SEE L9428			
Written by: MAS	Checked by: JRZ			

Unit _____ Phase _____ Stage _____ Stratum _____ PoM _____

Summary

Opened: WAS A ^{ROBBER TRENCH} FOR L9428 AND SO WAS OPENED AS A LOCUS DISTINCT FROM THE SEALED L18204.

Limits (N) W18226

(S) L18204, L18211, L18222

(E) L18204, L18211, L18222

(W) W9515

Closed: THE SOIL HAD BECOME SIMILAR TO L18222 AND WE CAME ACROSS A SCRAPPY FLOOR- L18238

Matrix: LIGHT BROWN LOOSE SOIL WITH SMALL KURKAR PEBBLES. POTTERY READING WAS ROMAN WITH A FEW IR2C.

Relations: Loci ABOVE: L18203 WAS COVERED BY L9428 ALTHOUGH L18203 MAY HAVE CUT L9428. THIS WAS NOT DETERMINED IN THE 1988 EXCAVATION SEASON. F9428 WAS CUT BY N: L18203 REACHES W18226. E: L18203 REACHES W9515. S&W: L18203 CUTS F9428, L18204, L18211 AND L18222. Loci BELOW: L18203 COVERS L18238.

L18203 must have robbed some feature, certainly not concrete F9428. Perhaps there was a small wall or installation in the NE corner of this room

* Apparently L18203 came down onto floor 18222, as L18222 and L18203 subsequently collapsed into fill & fill below locus = L18238

Additional Observations/Value: LOW VALUE ROBBER TRENCH CUTTING ROMAN CONCRETE FLOOR.

Locus

L 18203

Sketch plan

--- = L9428, L18204, L18211,
--- = L18222
... = L18238

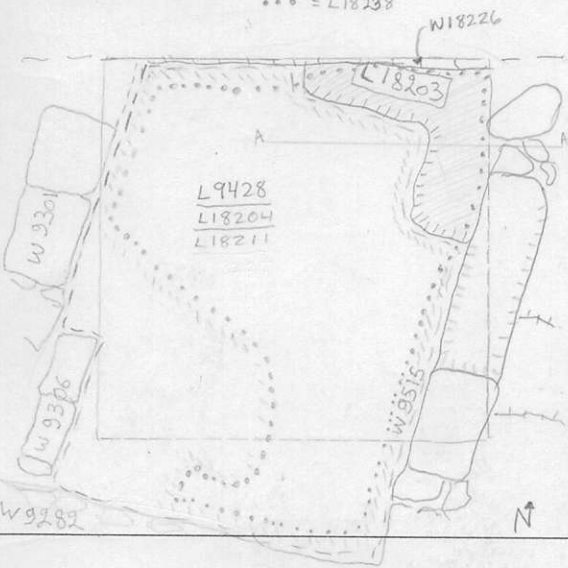

Photo

Photo

Section

FACING NORTH

Section

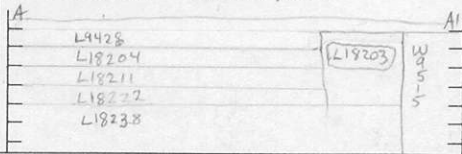

NOT TO SCALE