

Locus L 18202	Dor 19 ₉₇	Fld G	Sq AH34	Loc. type RT down to wall/Erosion?
Open Date 08/07/97	High at 15.20 N	Low at 15.15 G	Seals: _____	
Close Date 08/07/97	15.09 N	15.02 G	Sealed by: _____	
Floor: type _____	Length 2.9	Width 0.77	Vol _____	Loci 18231- _____
Value 4	Remove / /	Drawn? N.O.		above _____
Photo # (1) ^{SEE} L9231	Photo # (2) ^{SEE} L9231	Loci 18206 _____		
Written by: MAIS	Checked by: JRZ	below _____		

Unit _____	Phase _____	Stage _____	Stratum _____	PoM _____
------------	-------------	-------------	---------------	-----------

Summary _____

Opened: L18202 WAS OPENED TO EXCAVATE POTENTIAL RT TO THE EAST OF F9231. IT IS A RT BETWEEN THE WALL AND F9231. WE DON'T WANT THE MATERIAL FROM THE RT MIXING.

- Limits (N) BOUNDED BY BALK
- (S) BOUNDED BY W9282
 - (E) BOUNDED BY W9301 AND UNNUMBERED MATERIAL NORTH OF W9301.
 - (W) BOUNDED BY F9231

Closed: CAME DOWN ON W18206

Matrix: ^{HARD} SPARK BROWN SOIL WITH SMALL ROCKS. SMALL AMOUNT OF MUDBRICK MATERIAL ON TOP OF W18206 - SAME COLOR AS SOIL ABOVE.

Relations: Loci ABOVE: L9231 PROBABLY CONTAINED MATERIAL OF THE RT L18202 BUT IT WAS NOT DETERMINED AT THE TIME OF EXCAVATION OF L9231

NORTH: L18202 CONTINUES INTO BALK

EAST: L18202 REACHES W9301 AND AN UNNAMED AREA TO THE NORTH OF W9301.

SOUTH: L18202 REACHES W9282(6)

WEST: L18202 CUTS BOTH L9231 AND F9231

LOCI BELOW: L18202 CUTS W18206

JRZ 98: Possibly L18202 is simply erosional wash on top of the stones visible in this same area in 1998. Note that in-situ vessels were found here in 88!

* If L18202 pt of RT of Western face of W9301 = 9245. L9231 which appears between L9245 and L18202 contains the continuation of the RT. Rubble at bottom of L18202 is what's left over from W9301's RT

Additional Observations/Value: LOW VALUE. NO SIGNIFICANT POTTERY. POST ROMAN.

LOCUS
4 18202

Sketch plan

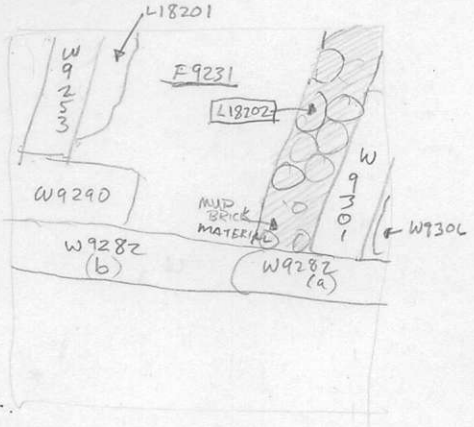

Photo

Photo

Section

Section

L18202 = [shaded square]

CIRCLES = [shaded circle] INDICATE W18206 BELOW.