

Focus L18083	Dor 1994	Fld 16	Sq AT32	Loc. type FLOOR MAKEUP FILL Below
Open Date 02/08/94	High at 12.91	at S	Low at 11.92	at N
Close Date 04/08/94	High at 11.90	at N	Low at 11.83	at SW
Floor: type length 0.5	Width 0.5	Vol	Drawn? NO	Seals: _____ Sealed by: _____
Value D?	Remove 04/08/94			Loci L18070 above _____ below _____
Photo #(1) -	Photo #(2) -			Loci L18091 above _____ below _____
Written by: JGM	Checked by: JRZ			

Unit	Phase	Stage	Stratum	PoM
------	-------	-------	---------	-----

Summary

Opened: CAME DOWN ON INSTALLATION L18082 AND F18070 WHILE EXCAVATING. L18070. AREA TO THE WEST OF L18082 CHANGED TO [L18083]

Limits (N) BAULK UNDER L9805  
 (S) L18070  
 (E) L18082  
 (W) BAULK BESIDE W9804

Closed: DISCOVERED THAT [L18083] WAS DEGRADED FLOOR MATERIAL OF F18070 WHICH WAS DAMAGED DURING THE CUTTING ACTION OF BASIN L18082, COLLAPSED TO L18091.

Matrix: GREY ASHY FLOOR MATERIAL. SANDY AND MEDIUM PACKED. DARKER AND ASHIER THAN L18070 ABOVE. MORE LOOSE THAN L18091 BELOW.

Relations: L18070 COVERS BUT DOES NOT SEAL [L18083]. BASIN L18082 CUTS [L18083]. [L18083] CONTINUES WEST INTO THE BAULK BESIDE W9804. [L18083] CONTINUES SOUTH AND EAST AS F18070 AND DOWN AS L18091

Additional Observations/Value: DEGRADED PORTION OF FLOOR. LOW VALUE

Locus  
E80817

Sketch plan

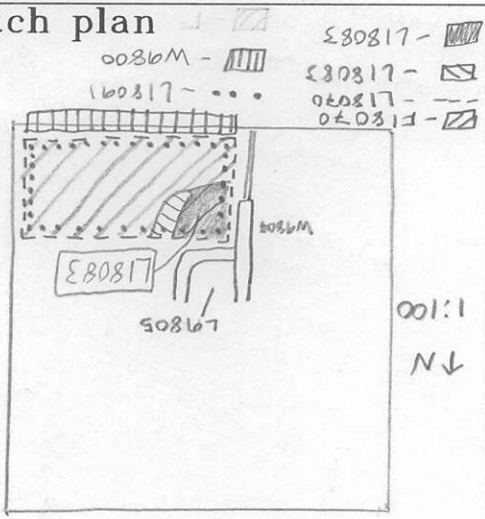

Photo

Photo

Section

Section