

Locus
L18072

Dor 19₉₄

Fld 51

Sq ALLIS2

Loc. type

destruction layer to floor

Open 218/07/94 Date High at Low at
113.017 112.815
 Close 015/08/94 112.611 112.513
 Floor: type 01E Width M Vol 112.519 Sl
 Length 01.5 Remove NO / / Drawn? NO
 Value 51

Photo #(1) Photo #(2)

Written by: CLB Checked by: JRZ

Unit	Phase	Stage	Stratum	PoM
Summary				

Opened: Opened L18072 as destruction material (continuing from L18069 above) to the destruction floor below. Around L18073

Limits (N) L18058

(S) L18073

(E) L18058

(W) L9982

Closed: IN A CRAZY MISTAKE OF EXCAVATION, WENT BELOW L18072, INTO MATERIAL BELOW, STOPPED - END OF SEASON.

Matrix: DESTRUCTION MATRIX AS THOSE MANY, MANY DESTRUCTION LOI AROUND

POWDERY BRIGHT REDS, ORANGES, AND WHITES WITH A SMATTERING OF FISTSIZED CLODS OF BURNT MUDBRICK. THIS LOCUS PRODUCED HALF AN INCH DEEP GRINDING VESSEL AND SOME IN SITU VESSELS ON THE FLOOR. IRON AGE, BEYOND THINKING OF A DOUBT.

Relations: L18072 WAS COVERED BUT NOT SEALED BY L18069 ABOVE. HOWEVER, L18069 IS SEALED BY A FLOOR, F/L18038 WHICH SEALS ALL DESTRUCTION DEBRIS BELOW.

TO THE NORTH, F/L18072 CONTINUES INTO L18058.

TO THE SOUTH, F/L18072 REACHES BIN L18073, CONTINUES INTO 9779 AND 9832 EXCAVATED 1193.

TO THE EAST, F/L18072 REACHES (OR SUSPECTS) L9982.

TO THE WEST, F/L18072 CONTINUES INTO L18058.

WENT BELOW F18072 INTO EARLIER MATERIAL (BUT NOT BY MUCH.) NO FINDS KEPT.

CLOSED @ END OF SEASON

See
15KA

Unit	Phase	Stage	Stratum	PoM
Summary				
Opened: Opened L18072 as destruction material (continuing from L18069 above) to the destruction floor below. Around L18073				
Limits (N) L18058				
(S) L18073				
(E) L18058				
(W) L9982				
Closed: IN A CRAZY MISTAKE OF EXCAVATION, WENT BELOW F18072, INTO MATERIAL BELOW, STOPPED - END OF SEASON.				
Matrix: Destruction matrix as these mainly, mainly destruction loci around powdery bright reds, oranges, and whites with a smattering of fist-sized clods of burnt mudbrick. this locus produced half an entire basket grinding vessel and some in situ vessels on the floor. IRON AGE, beyond thinking of a doubt?				
Relations: L18072 was covered but not sealed by L18069 above. However, L18069 is sealed by a floor, F/L18038 which seals all destruction debris below it.				
To the north, F/L18072 continues into L18058.				
To the south, F/L18072 reaches bin L18073, continues into 9779 and 9832 excavated in 93				
To the east, F/L18072 reaches (one suspects) L9982.				
To the west, F/L18072 continues into L18058.				
Went below F18072 into earlier material (but not by much.) No finds kept				
CLOSED @ end of season				

Additional Observations/Value: Low Value other than reaching the bin. L18073. As it is a disturbed locus.

LOCUS
L 18072

L18069 ABOVE
L18072
L18073
L18088 ABOVE

Sketch plan 1:100

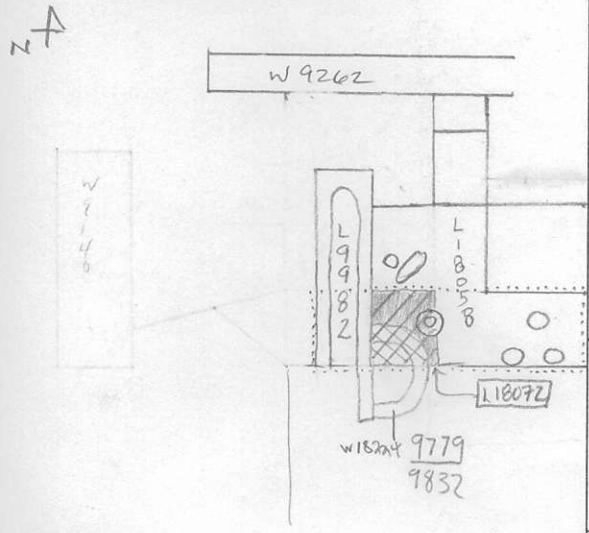

Photo

Photo

Section

Section

