

Locus L18064	Dor 1914	Fld 6	Sq A131	Loc. type CARD I (of II) DESTRUCTION ROOF DOWN TO FLOOR
Open 26/07/94	High 12.80	at SE	Low 12.62	at NE
Close 27/07/94	12.38	SE	12.39	NE
Floor: type SIP	Length 1.9	Width 0.6	Vol	
Value S	Remove 27/07/94	Drawn? NO		
Photo #(1) -	Photo #(2) -			
Written by: JCM	Checked by: JRZ			

Unit	Phase	Stage	Stratum	PoM
------	-------	-------	---------	-----

Summary

Opened: CAME DOWN ON DESTRUCTION ROOF F1807 WHILE EXCAVATING L18047. CHANGED TO L18064 AS ROOF MATRIX AND DESTRUCTION DOWN TO FLOOR.

Limits (N) L18033

(S) L18033

(E) L18033

(W) BAULK UNDER DRAIN L9025

Closed: CAME DOWN ON F18033. COLLAPSED WITH L18033 TO L18078

Matrix: ROOF CONSISTED OF THREE PARTS; PACKED MUD, REED MATTING, AND BURNT BEAMS. THE MUD LAYER IS ABOUT 3.0 cm THICK AND APPEARS AS A STRIATED LINE OF MUD IN PARTS OF THE BAULK. WHERE THE FIRE IS MOST INTENSE IT LOOKS LIKE A LAYER OF BRIGHT RED ERODED MUDBRICK. IT

Relations: SEEMS AS THOUGH SOME MUD SEEPED THROUGH THE MATTING, OR THAT THE CEILING WAS COATED ON THE UNDERSIDE AS WELL. THE REED MATTING APPEARS AS A NEGLIGABLE WHITE LINE, TO 3cm THICK WHITE ASHY LAYER WHERE FIRE WAS MOST INTENSE IN THE NORTH WEST CORNER. IT APPEARS AS THOUGH THE REED WAS WOVEN AROUND THE BEAMS AS MATTING OFTEN APPEARS ABOVE AND BELOW BEAMS. TWO KINDS OF BEAMS EXISTED. LARGE BEAMS (9-10cm THICK) RAN NORTH-SOUTH AND WERE PROBABLY INTENDED AS WEIGHT BEARING. EVIDENCE FOR ONE SUCH BEAM LYING BURNT ACROSS THE THRESHOLD OF W1800 ON A EAST-WEST ORIENTATION. THIS WAS MAYBE A WOODEN LINTEL. THE BEAMS WHICH HELD THE REED MATTING AND PACKED MUD APPEAR TO SIT ABOVE THE LARGE BEAMS IN THE EAST BAULK. THESE BEAMS ARE ROUGHLY 2.5-3.0cm THICK AND RANGE FROM 1.0cm TO 20cm APART. THEY WERE PROBABLY MORE UNIFORMLY PLACED BEFORE DESTRUCTION. THE MATERIAL BELOW THE ROOF IS STANDARD ORANGE AND BLACK DESTRUCTION MATERIAL. THIS MATERIAL ALSO CONTAINED ONE BROKEN RESTORABLE VESSEL.

FOR RELATIONS SEE CARD II
Additional Observations/Value: SEALED MATERIAL BETWEEN DESTRUCTION ROOF AND FLOOR. HIGH VALUE



LOCUS
190317

Sketch plan

Lh0817 - [hatched] F18047
 ΣΣ0817 - [diagonal lines] Lh0817 - 000
 h90817 - +++ ΣΣ0817 - . . .

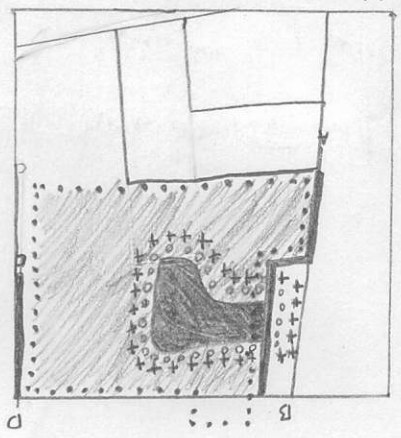

1:100
 ↓ N

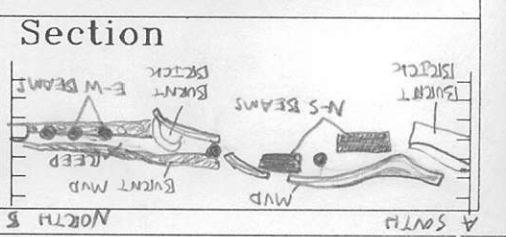
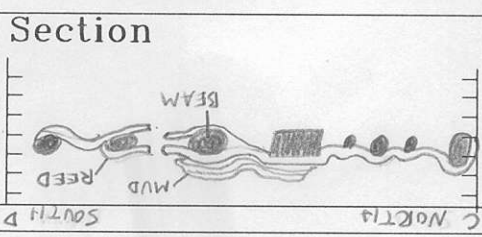

Locus <u>L18064</u>	Dor <u>1974</u>	Fld <u>6</u>	Sq <u>A1311</u>	Loc. type <u>DESTRUCTION ROOF DOWN TO FLOOR. CARP</u>		
Open	Date	High	at	Low	at	Seals: _____
Close						Sealed by: _____
Floor: type						Loci
Length	Width			Vol		above
Value	Remove			Drawn?		below
Photo #(1)		Photo #(2)				
Written by: _____		Checked by: _____				

Unit _____	Phase _____	Stage _____	Stratum _____	PoM _____
------------	-------------	-------------	---------------	-----------

Summary _____

Opened: _____

Limits (N) _____
 (S) _____
 (E) _____
 (W) _____

Closed: _____

Matrix: _____

Relations: L18047 SEALS [L18064]. SINCE L18047 AND L18064 WERE LEFT UNEXCAVATED UNTIL L18033 HAD BEEN BROUGHT DOWN TO DESTRUCTION F18033 LEVEL, WE ARE LEFT WITH THE UNUSUAL CASE IN WHICH THE DESTRUCTION MATERIAL OF L18033 CONTINUES INTO L18047 ABOVE ROOF F18047 AND BELOW INTO [L18064] FROM NORTH, EAST, AND SOUTH. AS THE SAME MATERIAL FLOOR MATERIAL OF F18047 WAS NO DOUBT EXCAVATED IN L18033, AND F18047 MAY HAVE ORIGINALLY SPANNED THE ENTIRE SQUARE. THUS THE SEPARATION BETWEEN MATERIAL ABOVE F18047 AND BELOW IN [L18064] IS IMPORTANT IN UNDERSTANDING THE DIFFERENCE BETWEEN DESTRUCTION ABOVE AND BELOW ROOF F18047. [L18064] ALSO COMES DOWN ON F18033 WHICH SEALS L18078. [L18064] also continues west into the debris below drain 9025

Additional Observations/Value: _____

Locus

Sketch plan

Photo

Photo

Section

Section

