

Locus L 18060	Dor 19 94	Fld G <sub>1</sub>	Sq A 1132	Loc. type Destruction level to installation
Open	Date 26/07/94	High at 113.41	Low at 113.23	Seals: _____
Close	28/07/94	113.34	113.14	Sealed by: _____
Floor: type				Loci 18050 18052
Length 1.6	Width 1.3	Vol	Drawn? No	above _____
Value 11	Remove 28/07/94			Loci L9982 181069
Photo #(1) 117725	Photo #(2) 117730			below _____
Written by: CAB	Checked by: JRZ			

Unit	Phase	Stage	Stratum	PoM
------	-------	-------	---------	-----

Summary \_\_\_\_\_

Opened: Opened L18060 to redefine excavated areas of L18050 and L18052. L18050 + L18052 were collapsed to form L18060, dividing L18052 into L18060 + L18068 and expanding excavated area.

Limits (N) L9978  
 (S) L9965  
 (E) L18058  
 (W) L18068

Closed: Closed L18060 to redefine excavated area to East to search for the top of the bin seen in section from the south (18073)

Matrix: Destruction debris bright reds oranges and white with powdery consistency, mixed with burnt mudbricks in orange, purple, green and red. Iron Age pottery sherds.

Relations: L18060 is <sup>partially</sup> covered and not sealed by L18052; L18050 also partially covers L18060, and seals this area. However all debris in L18060 is uniform.

To the North, L18060 continues into the lower destruction debris of L9978, and L18058.

To the South, L18060 continues into L9965 and L9979 below.

To the East, L18060 continues into L18058.

To the West, L18060 continues into L18068.

L18060 was closed when the extension of the installation L9982 into L18060 was defined i.e. we reached the top of the installation. To the east of the top of the installation in the area L18060 had covered, L18069 was opened to attempt to define the top of the bin seen in section from south to north. (the bin was found, bin L18073, non bin area below L18069 assigned L18072.)

The installation top is trough-shaped (inverted W-shaped) along its length. And with its associated bins to the east, might possibly have been an industrial bread making ?? center - where the in situ situation in L18058 with pottery vessels, a table, a grinding vessel, hand pestle and long pestle of basalt would have been used in connection with the "grain bin" and kneading installation.

Add Photos: 117734, 117738  
 Additional Observations/Value: L18060 has high value for reaching the top of the installation L9982, and defining the shape of L9982, which was unclear until now.



117734



117738

**Locus**  
L 18101610

- |  |              |  |        |
|--|--------------|--|--------|
|  | L18052 Above |  | L18072 |
|  | L18060       |  | L18073 |
|  | L18069 below |  | L18050 |
|  | L18068       |  | L18058 |
|  | L9978        |  |        |

Sketch plan

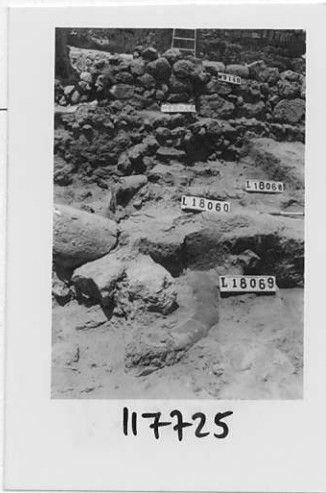
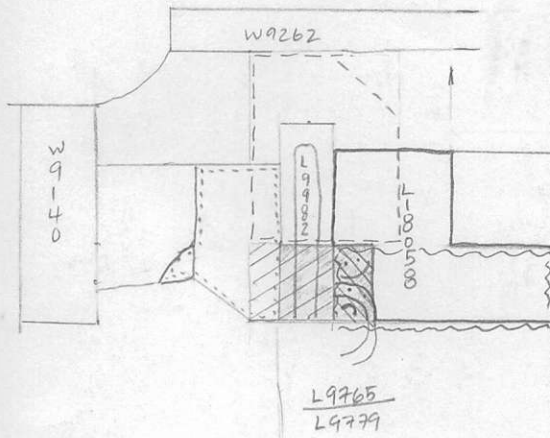

117725



117730

Section

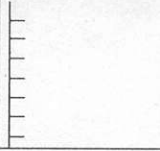

Section

