

Locus W18048	Dor 19 ₉₄	Fld G ₁	Sq A1321/3311	Loc. type Stone wall
Open	Date 1/4/87/84	High at 113.69 S ₁	Low at 113.59 G ₁	Seals: _____
Close	05/08/94	112.86 N ₁	112.64 S ₁	Sealed by: 913010 _____
Floor: type	_____	_____	_____	Loci 18026 18013 18012 93001
Length L ₁	Width 0.3	Vol _____	_____	above 91140 _____
Value S ₁	Remove _____	Drawn? No	_____	Loci _____
Photo #(1) 11729	Photo #(2) 11737	_____	_____	below _____
Written by: CAB	Checked by: JIR2	_____	_____	_____
Unit _____	Phase 9+8	Stage _____	Stratum _____	PoM _____

Summary

Opened: Opened W18048 when during the course of excavating L18026 a row of stones was defined running parallel along the length of W9140.

Limits (N) Pit L9168

(S) L9826, L9829

(E) L18035, L18036, L18057, L18087, L18061

(W) W9140

Closed: end of season continues, not closed

Matrix: Wall is constructed of undressed stones double head to double fist sized with the major of stones (approx. 75%) being double fist sized. Interstices of the stone wall is filled with hard packed dirt. The upper courses of W18048 lean out to the west, showing the direction of the collapse. Much rubble from W18048 was found in 18061, 18087 and 18087. W18048 has 5 courses exposed to the floor level of the destruction.

Relations: W18048 is covered but not sealed by L18026. L18026 is covered but not sealed by L18013, and F18012 reaches W9140. F18012 + L18013 are covered and sealed by pavement L9300.

east of W18048. Below L18026, the installation L18036 reaches W18048. The debris around L18036, L18035 reaches both L18036 and W18048, and comes down upon the stone pavement F18035.

F18035 is partially covered by L18036. F18012's NW fragment, which reaches W9140, has exactly the same matrix as L18036 which seems to curve up and possibly over W18048 therefore, F18012 = L18036 and both reach W9140 + W18048.

F18035 does not reach W18048, and therefore W18048 may cut F18035. Nope, impossible! JR294

The debris below and east of F18035 is L18057, which reaches W18048.

Below L18057, the destruction layer was reached, assigned 18087. L18087 reaches W18048.

Also below L18035, L18061 "the destruction layer" reaches W18048. the F18087, another stone pavement, also reaches W18048

To the North, W18048 is cut by the pit L9168.

To the South, L9826 and L9829 below reach W18048

To the West, W9140 is laid atop W18048.

End of season, did not reach bottom of W18048, not closed

W18048 may be built up against mudbrick wall W9915 partially below W9140 on the West.

Add. Photos: 117540 117690 117694-695, 117698

Additional Observations/Value: W18048 is of high value for being the western boundary to "Cath's destruction room".

→ And having 3 stone pavements, All Iron Age, relating to 2 phases/constructions of a stone wall. the only 3 Iron Age pavements in Area G.



117698



117690



117729



117695



117540

Locus
W 18048

L9300 ABOVE
F18012 ABOVE
L18013 ABOVE
L18026 ABOVE
W18048
L18036

F18035
L18057
L18061

Sketch plan 1:50

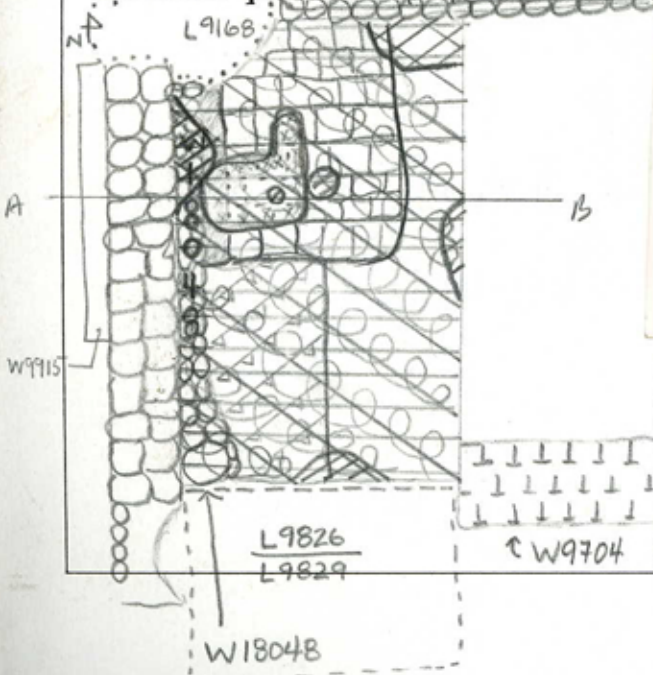

W9262



117537



117694

Section

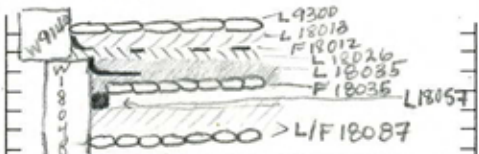

Section

A: from south to north B

Locus W 18,048	Dor 1997	Fld G	Sq A532	Loc. type Stone Wall (card 2)
Open Date 0.7/07/97	High at 13.58	at E.C	Low at 13.41	at W.C
Close Date 08/08/97	12.62	N	12.08	S
Floor: type	Length 3.0	Width 9.5	Vol	Seals: _____
Value 1	Remove	Drawn?		Sealed by: _____
Photo #(1) 166726	Photo #(2) 166728			Loci 9,14,9 above _____
Written by: JCM	Checked by: JRZ			Loci below _____

Unit	Phase	Stage	Stratum	PoM
------	-------	-------	---------	-----

Summary

Opened: see previous card

Limits (N) See previous card.

(S) L18214.

(E) L18216, L18221, W18229, L18235, L18234, L18289

(W) W9919, L18242

Closed: Not closed, end of season reached

Matrix: See previous card. In the northern half, there are 7-4 courses and in the south there are 6-10. Stones range from 5-25 cm in diameter and shaped roughly if at all.

Relations: Above: W9140 covers but does not seal W18048

North: see previous card

South: W18048 is reached by destruction material in L18214.

East: L18216/F18216 reaches W18048.

L18221 reaches W18048. The west stone pier of W18229 dovetails

with W18048. Floor L18235 above and L18234 below reach W18048.

L18289/F18289 reaches W18048 south of W18229.

West: W18048 and W9919 were built touching one another but

the temporal relation is unclear.

L18242/F18242 reach W18048

Below: North of W18229, F18221 extends eastwards under W18048.

North of W18229, W18048 bottoms out at 12.62 (North)/12.59 (South), whereas

South of W18229, it is still continuing down at 12.08 (North + South)

One could project the bottom of the northern section southwards to

make two constructional phases but this is unlikely for two reasons: (1) no

line can be ^{visually} determined to suggest two construction phases south of W18229, and (2)

W18229 dovetails with W18048 both above and below this hypothetical separation.

Additional Observations/Value: High Value.



167627



167630



167626



167000



143673



167001



167045



1676263



167046



167640

Locus

W 181048

Sketch plan

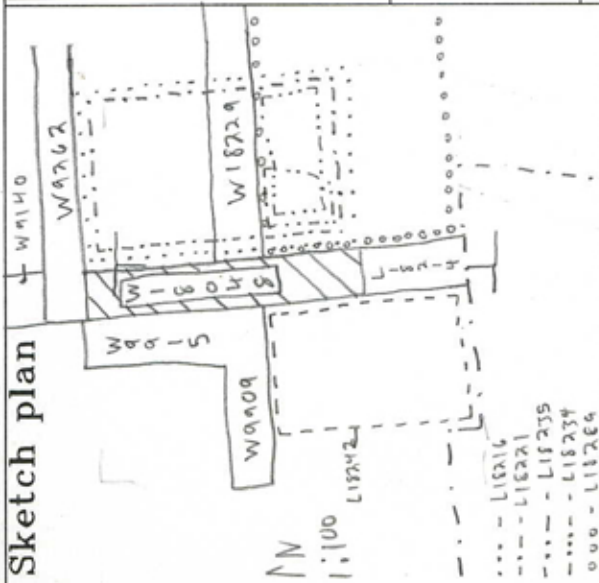

166726



166409



166408



167637



166265

Locus W 18048	Dor 19 9.8	Fld G	Sq AJ 32	Loc. type stone wall
Open Date 2.3/07/98	High at 13.6.9 S	Low at 13.5.9 C	Seals: _____	
Close Date 0.7/08/98	1.2.0.6 S	11.9.7 C	Sealed by: _____	
Floor: type _____	Length 1.1	Width 0.3	Vol _____	Loci see previous card
Value 1	Remove 1/1/1	Drawn? YES	above _____	
Photo #(1) 175789	Photo #(2) 175790	Loci _____	below _____	
Written by: HAK	Checked by: JAZ			

Unit _____	Phase _____	Stage _____	Stratum _____	PoM _____
Summary _____				

Opened: see previous card

Limits (N) see previous card

(S) L18344, L18354

(E) see previous card

(W) L18344, L18354

Closed: not closed

Matrix: see previous card

Relations: L18344 reaches W18048 from the west and south. F18344 and L18354 (floor makeup of a multiple resurfaced floor - the uppermost being F18344) dive below W18048. There were no surfaces at this level found on the east side of W18048.

W18048 may have a relation to W18332 as the two walls create a doorway. This is not yet clear.

Note that W18048 floats above L18354, suggesting that it is foundational at this level and that W18048 actually cuts F18344, though no foundation trench on the E or W face of W18048 was observed.

TO THE EAST: L18283 AND ALL LOCI BELOW CONTINUE IN BALK UNDER W18048. THE RED MUDBRICK PHASE OF W18283 REACHES A POSSIBLE ^{2nd} FLOOR IN W18048 (3-4 COURSES ABOVE STONE SOCLE OF W18283). THE STONE SOCLE OF W18283 ABUTS INTO SOUTH PART OF W18048.

* F18283 AND F18244 POSSIBLY MATCH F18344 + 18354 (DIVING BELOW W18048 FROM THE WEST)

Additional photos - 175791-794

Additional Observations/Value: High Value wall.

Locus
W 18048

Sketch plan



32



17552a



17552b

175636



Section A

Section B

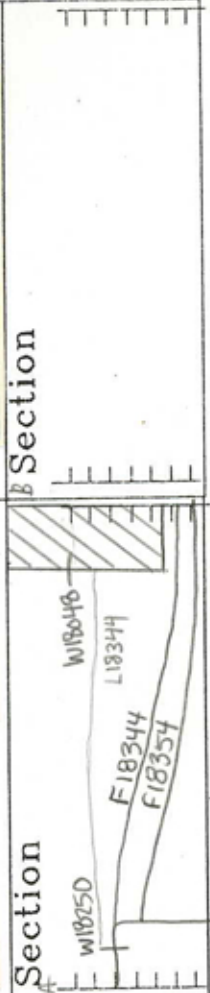

Looking North

Locus W 18048	Dor 19 ₉₉	Fld G ₁	Sq A ₁ , 3, 2	Loc. type WALL (SOUTHERN PART, CONTINUATION CARD)
Open	Date	High at	Low at	Seals: 18387
Close				Sealed by:
Floor: type	Width	Remove	Vol	Loci
Length		Drawn?		above
Value				Loci 18387
Photo #(1)	Photo #(2)			below
Written by: KV	Checked by: J.R.Z			

Unit	Phase	Stage	Stratum	PoM
------	-------	-------	---------	-----

Summary

Opened: W18048 (SOUTH) WAS REMOVED BECAUSE IT WAS FLOATING

Limits (N) PIER OF W18229 AND W9909

(S) TEMPORARY BALK

(E) L18368, L18378

(W) L18367, L18376, L18388

Closed: W18048 WAS REMOVED AND L18387 WAS OPENED BELOW

Matrix: FOUR TO FIVE COURSES OF IRREGULAR PLACED DOUBLE FIRST SIZE FIELD STONES laid two stones wide.

Relations: ABOVE: SEE PREVIOUS CARDS

NORTH: W18048 SOUTH SEEMS TO BE BUILT AGAINST THE PIER ON TOP OF THE JUNCTION OF W9909 AND W18229. THIS LEAVES TWO POSSIBILITIES OPEN. ONE IS THAT THE NORTHERN AND THE SOUTHERN PART OF W18048 ARE TWO DIFFERENT PHASES OR WALLS. HOWEVER, IT IS ALSO POSSIBLE THAT BOTH PART ARE SIMPLY THE FOUNDATIONS OF A SINGLE WALL W18048 *

SOUTH: (see previous cards)

EAST: THE PILLS OF L18368 AND 18378 CONTINUED ALREADY INTO BALK UNDERNEATH W18048 AND DID NOT REACH THE WALL

WEST: F18367 AND THE PILLS OF L18367, L18376 AND L18388 ALL CONTINUE INTO THE BALK UNDERNEATH W18048

BELOW: L18387 WAS OPENED BELOW (AND IS SEALED BY) W18048 SOUTH

* In photos of W18048 S from 1994, when it was uncovered, it looks like W18048 S was very poorly preserved, basically at floor level. It is possible that most of W18048 S, as excavated, was mostly the foundation and that it was built up against the pre-existing W18229 stage a (the piers), which was also reused as a foundation for superstructure parts of W18048 S in local Phase 9 destruction.

Additional Observations/Value: MEDIUM VALUE, Crumbly Wall.

Locus

W 18,048

Sketch plan

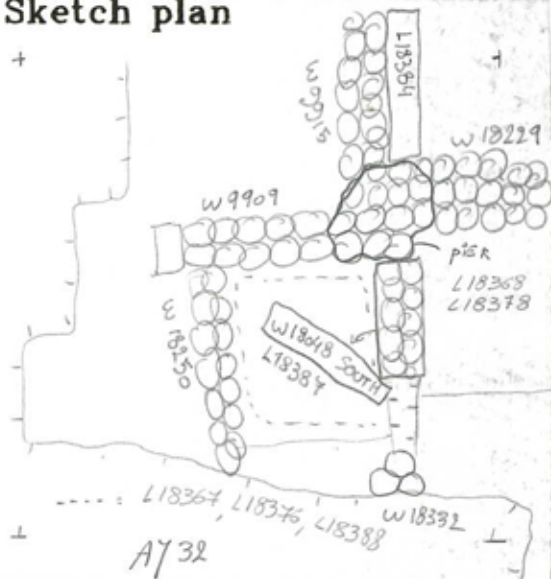

L18381

Photo

Section

Section

Locus W 18048	Dor 19,99	Fld G ₁	Sq AJ 32-33	Loc. type WALL, NORTHERN PART (CONTINUATION CAN)
Open 09/17/99	Date	High at 1.3-1.5 s ₁	Low at 1.2-1.3 M	Seals: 18384
Close 14/27/99		Remove 1.5/0.7/99	Drawn? yes	Sealed by:
Floor: type				Loci
Length 1.5	Width 0.5			above
Value 4				below
Photo # (1)		Photo # (2)		Loci 18384
Written by: KVL		Checked by: J.R.Z.		

Unit	Phase	Stage	Stratum	PoM
-------------	--------------	--------------	----------------	------------

Summary

Opened: W18048 WAS FLOATING AND WE DECIDED TO REMOVE IT

Limits (N) } SEE PREVIOUS CARDS
 (S)
 (E)
 (W)

Closed: W18048 (= NORTHERN PART) WAS COMPLETELY REMOVED

Matrix: FIELDSTONES OF ± DOUBLE FIST SIZE TO HEADSIZE IN COURSES OF NOT MORE THAN TWO STONES WIDE. ON ITS SIDE TO W 9915 THE STONES WERE PACKED INTO THE ORANGE MUDBRICK OF W 9915. W18048 IN ITS NORTHERN EXTENSION GIVES THE IMPRESSION THAT IT WAS NEVER A SELF STANDING WALL.

Relations: ABOVE: SEE PREVIOUS CARDS

NORTH: DITTO

SOUTH: BY CLEANING THE SOUTHERN HALF OF W18048 IT APPEARED TO US THAT THIS PART MIGHT ACTUALLY BE A SEPERATE WALL BUILT AGAINST THE NORTHERN HALF OF W18048 AND THEREFORE NOT PART OF THE SAME CONSTRUCTION sub phase, though it is likely that the entire wall was constructed in the same overall phase

EAST: DITTO

WEST: WHEN THE MUDBRICK PHASE OF W 9915 WAS REMOVED IT WAS VISIBLE THAT THE NORTHERN HALF OF W18048 WAS BUILT AGAINST IT IN A LATER STADIUM AS A SORT OF EASTERN FACING. W18048 IS THERE ONLY ONE STONE WIDE. THE FACT THAT THE RED MUDBRICK OF W 9915 IS HALFWAY^{FOR} PRESENT IN THE WESTERN CREVICES OF W18048 CAN BE EXPLAINED BY POST DEPOSITIONAL PRESSURE OF THE FILLS ABOVE THE TOP WALLS.

BELOW: L18384 IS SEALED BY W18048

Note also that it seems likely that several close multiple resurfacings of a floor associated with the broad preceding trough room ran under W18048 and likely reached the east face of W 9915, most likely the mudbrick stage A

Additional Observations/Value: HIGH VALUE

Locus

W 18048

Sketch plan

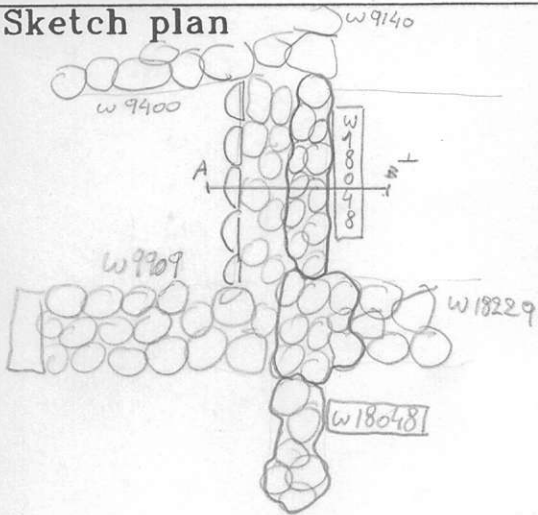

AT 32-33

184488

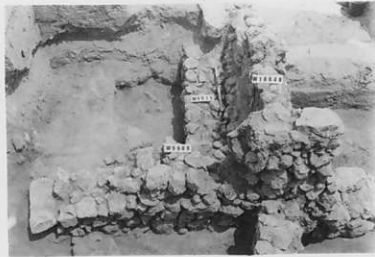

184490



Section A-B

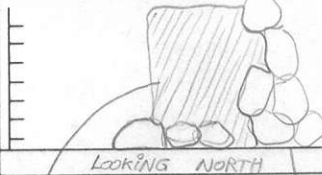

MUDBRICK PHASE OF
W 9915

W 18048

Section

