

Locus L 1,800A	Dor 1914	Fld G	Sq A131	Loc. type FILL TO FLOOR
Open Date 04/07/44	High at 13.59	Low at 13.45	Seals: _____	
Close Date 05/07/44	13.34	13.15	Sealed by: _____	
Floor: type CP	13.36	13.15	Loci SAULK _____	
Length 1.4	Width 9.8	Vol _____	above _____	
Value NS	Remove 06/07/44	Drawn? YES	Loci 1,800A 1,801B _____	
Photo #(1) 11703A	Photo #(2) 117042		below _____	
Written by: JCM	Checked by: JRZ			

Unit _____	Phase _____	Stage _____	Stratum _____	PoM _____
------------	-------------	-------------	---------------	-----------

Summary \_\_\_\_\_

Opened: BEGINNING OF SEASON. EXCAVATED BULK TO ELUCIDATE DESTRUCTION LAYER IN A132 AND L9091 IN A131

Limits (N) L9727 (A132)  
 (S) L9912, L9911, L9910  
 (E) BULK  
 (W) BULK

Closed: CAME DOWN ON DESTRUCTION LAYER IN THE WEST AND AN EXTENSION OF F9727 IN THE EAST

Matrix: GREY SANDY AND ASHY SOIL WITH MUCH POTTERY. BONE DAGGER HANDLE (#180042) FOUND HERE JUST ABOVE THE JUNCTION BETWEEN THE CHANGES BELOW. DIFFERS FROM MUDBRICK DEBRIS IN L18009 BELOW AND RED ASHY DESTRUCTION IN L18017 BELOW

Relations: THE NORTH BULK OF A131 WAS REMOVED AND COVERED [L18001]. FROM THE SOUTH L9910 CONTINUES INTO [L18001], WHILE THE MUDBRICK DEBRIS FROM L9911 AND L9912 SEEM TO REACH THIS ASHY DEPOSIT. L9727 FROM A132 TO THE N APPEARS TO CONTINUE SOUTH AS [L18001], AND INDEED F9727 WHICH WAS SAID TO CONTINUE INTO THE BULK, IS VERY LIKELY THE FLOOR ENCOUNTERED WHILE EXCAVATING [L18001]. DUE TO PARTIAL NATURE OF F9727, F9727 IN A131 DOES NOT SEAL L18009 BELOW ON THE EAST. [L18001] ALSO COVERS BUT DOES NOT SEAL DESTRUCTION LAYER L18017 ON THE WEST SIDE OF THE LOCUS.

Possibly the same as L9910?  
 Note: In Photos the [L18001] was equated with [F9661] in A132 and given that number. It is much more likely that [L18001] = [F9727] as they are at the same elevation and both are above destruction water.  
 Additional Observations/Value: FILL ABOVE PARTIAL FLOOR. BONE DAGGER HANDLE FOUND. HIGH VALUE



Locus  
L 18001

Sketch plan

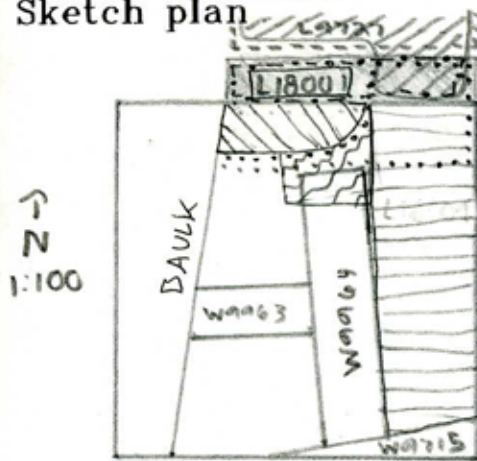

- |  |         |  |        |
|--|---------|--|--------|
|  | -F9727  |  | -L9910 |
|  | -L9727  |  | -L9911 |
|  | -L18017 |  | -L9912 |
|  | -L18009 |  |        |

ohotvv



Section



vhottv



Section

