

KM 222

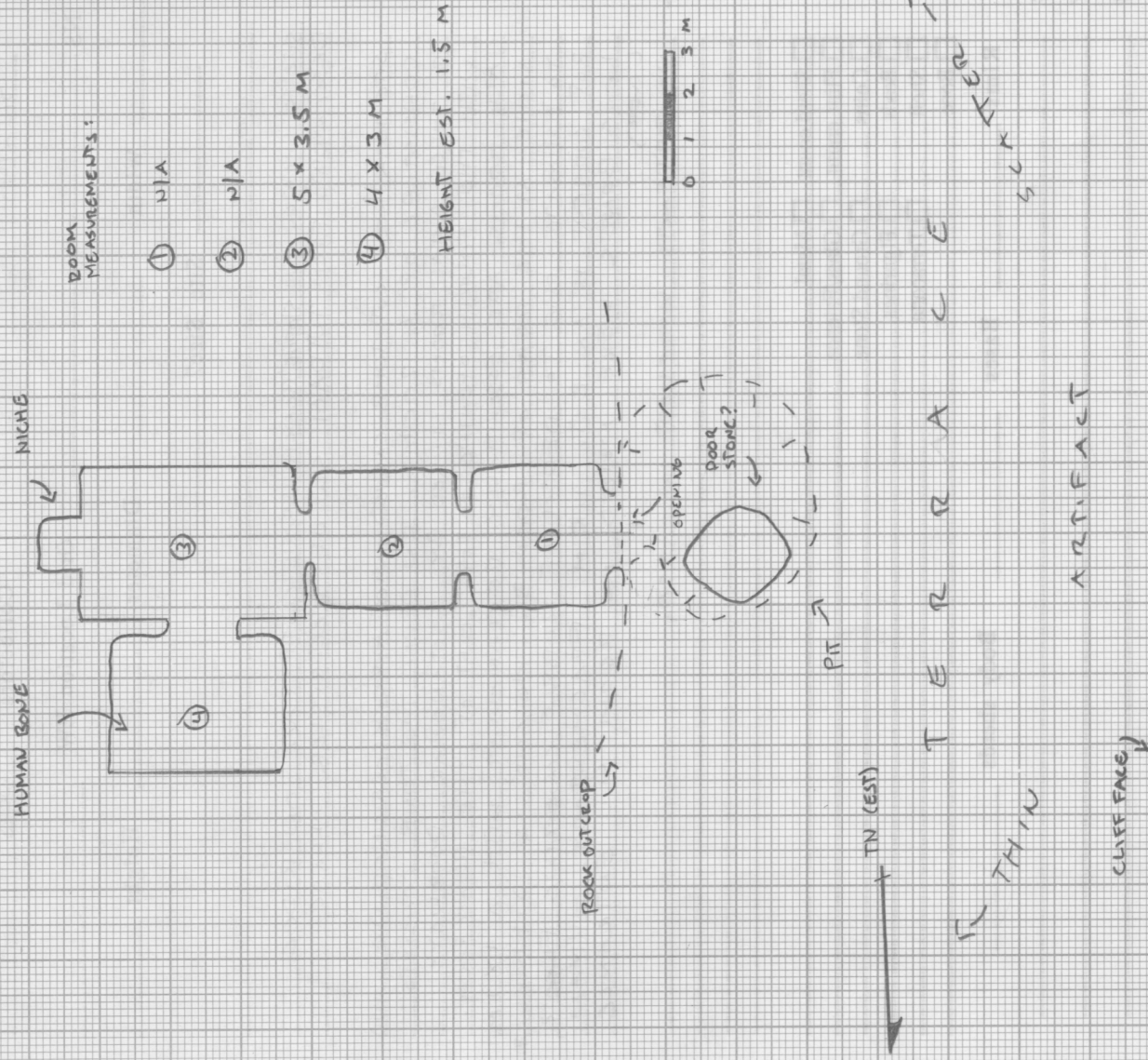

ROOM MEASUREMENTS:

- ① N/A
- ② N/A
- ③ 5 x 3.5 M
- ④ 4 x 3 M

HEIGHT EST. 1.5 M

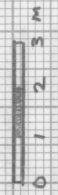

(DESCR. CONT.) TO THE TOMB IS VIA A SHALLOW PIT IN THE NATURAL TERRACE; A LARGE BUIDER, APPARENTLY ONCE USED TO BLOCK THE OPENING, IS AT ONE SIDE. THE OPENING ITSELF IS ARCHED.

A THIN SCATTER OF CERAMICS, APP. ROMAN BUT HIGHLY ERODED, ARE PRESENT IN THE VICINITY AND WERE NOTED A CONSIDERABLE DISTANCE DOWNSLOPE. THEY MAY REPRESENT VESSELS FORMERLY IN THE TOMB. A LOW FREQUENCY OF PRIMARY CHERT FLAKES IS ALSO PRESENT, BUT APPEARS TO RELATE TO THE GENERAL BACKGROUND SCATTER IN THE VICINITY.