

GPMP GIZA

Site: S A F S 2/L7A4 Area: KKT-N	GRID SQUARE(S) 201-E31	ARCHITECTURE	FEATURE 34298									
1. Material	1) MUDBRICK											
2. Size of materials	2) 0.39m (L) X 0.19m (W)											
3. Finish	3) REGULAR											
4. Coursing/bond	4) ONE ROW OF STRETCHERS (SOUTH) ONE ROW OF HEADERS (NORTH).											
5. Form	5) WALL											
6. Direction of faces	6) NW/SE.											
7. Orientation	7) NE/SW.											
8. Dimensions	8) 3.27m (L) X 0.56m (W).											
9. Associated collapse	9) UNKNOWN.											
10. Founds, cuts & fills	10) "											
11. Repaired	11) WITH (28372)											
12. Associated floors	12) UNKNOWN											
13. Plastered	13) "											
14. Wall core	14) POSSIBLY (34299)											
15. Types of brick (%)	15) UNKNOWN											
16. Composition of bricks	16) " 17) SEE # 2.											
17. Dimensions of bricks (sample of three)												
Stratigraphic Matrix		Abuts	Above									
<table border="1"> <tr><td> </td><td> </td><td> </td></tr> <tr><td> </td><td>34298</td><td> </td></tr> <tr><td> </td><td> </td><td> </td></tr> </table>						34298					Abutted by	Below
	34298											
		Bonded into										
		Contiguous with	(34306)(34297)(28371)									
INTERPRETATION		Enclosing	Internal									
Reason for decay		NOT EXCAVATED - NUMBER ASSIGNED DURING DATA										
Indications of original dimensions		CURATION PROJECT.										
Indications of original functions												
REMAINS OF THE ORIGINAL SOUTHERN WALL OF SPACE 11536 & THE NORTHERN WALL OF SPACE 11535. IN STRUCTURE 15258												
Associated contexts:												
Context Same As:												
Drawing Nos: 2007-186												
<u>Photographs</u> (feature in plan, elevation, materials used, surface treatment e.g. plaster, paint etc.)		<u>Finds</u>										
		Description	Artefact no.									
<u>Samples</u> (flotation, wet sieve, materials used e.g. bricks, stone, wood, bonding material etc.)												
Photograph No.	Description	Sample No.	Description									
		Phase:	Checked									
			Initials DCJ Date 03 APRIL 2013.									

(34298)

Sketch Drawings (in plan and in profile)

Remember: do not just draw the architectural feature in isolation. Show how it relates to surrounding features and include details of surface treatments, repairs/modifications/damage, bonding material(s), and associated cuts. Annotate all aspects of the feature or use a Drawing Key. Measurements must be included for all aspects of the feature and surrounding features.

Sketch Plan - Include grid co-ordinates, North arrow, and elevations.

NOT TO SCALE \uparrow
N
-0-
201-E31.

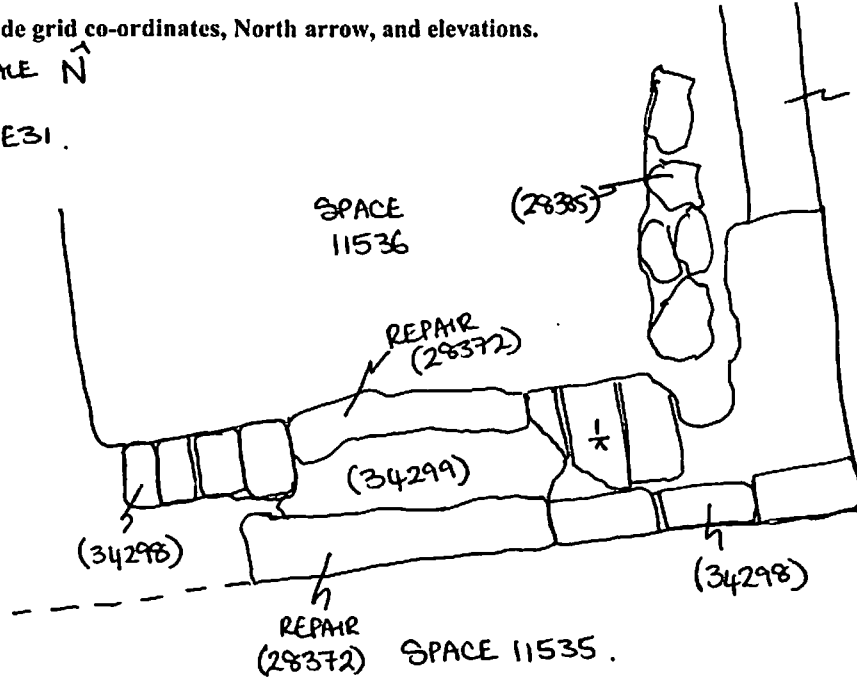

TBM: 21.38
BS: 1.24
IH: 22.62
FS PL
 $\frac{1}{\pi}$ 2.61 20.01.

Profile Sketch

- State direction the elevation of the feature being drawn is facing e.g. 'West Facing Elevation of Feature
- If feature was drawn in section then include the grid co-ordinates and elevations.