

GPMP GIZA

Site: SAPS 2/LFM Area: KKT-N		GRID SQUARE(S) 201-E32	ARCHITECTURE	FEATURE 34290									
1. Material	1) MUDBRICK												
2. Size of materials	2) 0.38m (L) x 0.19m (W) FROM PLAN												
3. Finish	3) REGULAR												
4. Coursing/bond	4) COMBINATION OF HEADERS & STRETCHERS												
5. Form	5) WALL												
6. Direction of faces	6) NE SW SE												
7. Orientation	7) NW SE												
8. Dimensions	8) 1m (L) x 0.86m (W)												
9. Associated collapse	9) UNKNOWN												
10. Founds, cuts & fills	10) "												
11. Repaired	11) WITH (28405)												
12. Associated floors	12) UNKNOWN												
13. Plastered	13) "												
14. Wall core	14) POSSIBLY (34291)												
15. Types of brick (%)	15) UNKNOWN												
16. Composition of bricks	16) "												
17. Dimensions of bricks (sample of three)	17) SEE #2												
Stratigraphic Matrix		Abuts		Above									
<table border="1"> <tr><td> </td><td> </td><td> </td></tr> <tr><td> </td><td>34290</td><td> </td></tr> <tr><td> </td><td> </td><td> </td></tr> </table>						34290					Abutted by		Below
	34290												
		Bonded into											
		Contiguous with											
INTERPRETATION													
		Enclosing		Internal External									
Reason for decay		NOT EXCAVATED - NUMBER ASSIGNED DURING											
Indications of original dimensions		DATA CURATION PROJECT.											
Indications of original functions													
REMAINS OF THE ORIGINAL SW CORNER OF STRUCTURE 1525A LATER REPAIRED WITH (28405). BOUNDARY WALL FOR SPACE 11532 AND STREET SPACE 11374													
Associated contexts:													
Context Same As:													
Drawing Nos: 2007-207													
Photographs (feature in plan, elevation, materials used, surface treatment e.g. plaster, paint etc.)		Finds		Samples (flotation, wet sieve materials used e.g. bricks, stone, wood, bonding material etc.)									
Photograph No.	Description	Description	Artefact no.	Sample No. Description									
		Phase:	Checked	Initials DCJ Date 02 APRIL 2013									

(34290)

Sketch Drawings (in plan and in profile)

Remember: do not just draw the architectural feature in isolation. Show how it relates to surrounding features and include details of surface treatments, repairs/modifications/damage, bonding material(s), and associated cuts. Annotate all aspects of the feature or use a Drawing Key. Measurements must be included for all aspects of the feature and surrounding features.

Sketch Plan - Include grid co-ordinates, North arrow, and elevations.

NOT TO SCALE

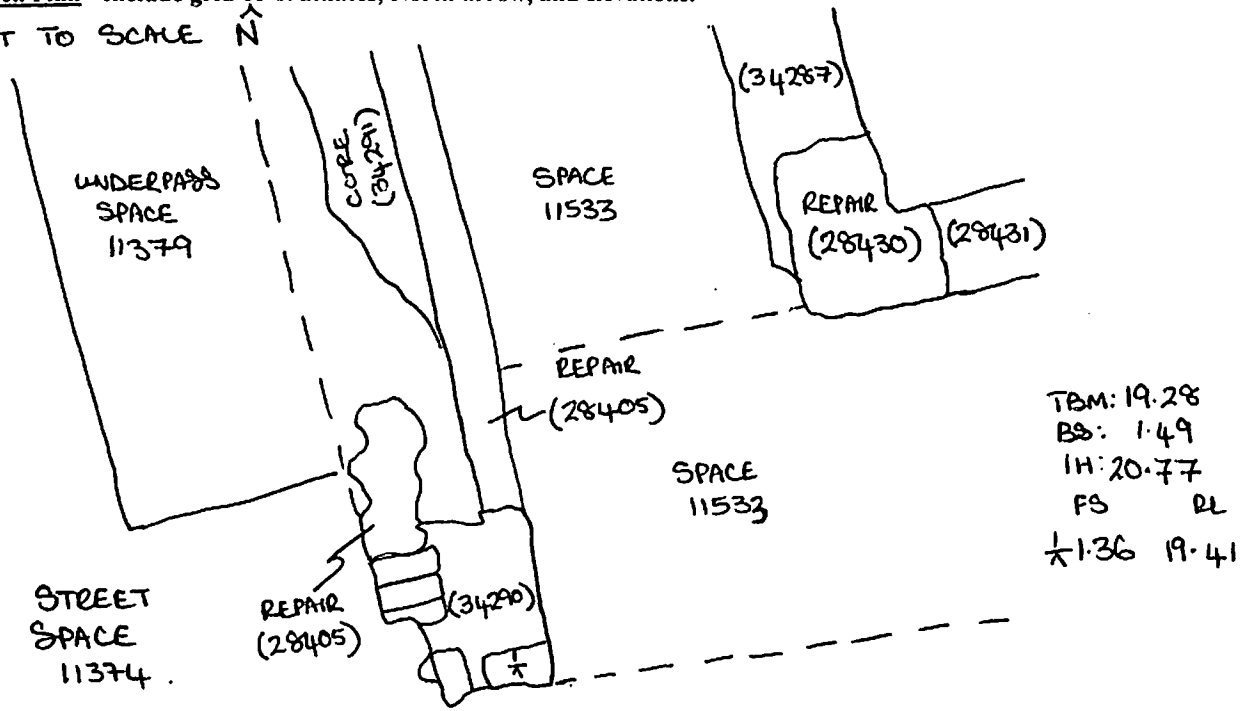

201-E32

Profile Sketch

- State direction the elevation of the feature being drawn is facing e.g. 'West Facing Elevation of Feature
- If feature was drawn in section then include the grid co-ordinates and elevations.