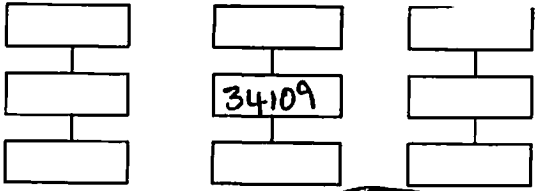

CPMP

| | | | |
|---|--|--------------|-------------------------|
| Site: SAPS 2 / LTM Area: MVT-E, KKT-A1 | GRID SQUARE(S) 101-L22, L23, M22 | ARCHITECTURE | FEATURE 34109 |
|---|--|--------------|-------------------------|

| | |
|--|--|
| 1. Material | 1) MUDBRICK. |
| 2. Size of materials | 2) UNKNOWN |
| 3. Finish | 3) APPEARS FROM PLAN TO BE REGULAR COURSED. |
| 4. Coursing/bond | 4) THREE PARALLEL ROWS OF HEADERS VISIBLE IN PLAN |
| 5. Form | 5) WALL |
| 6. Direction of faces | 6) NORTH & SOUTH |
| 7. Orientation | 7) E/W. |
| 8. Dimensions | 8) 3.67m (L) X 1.55m (W) X 0.15m HEIGHT. |
| 9. Associated collapse | 9) (32792) (32789) (32768) |
| 10. Founds, cuts & fills | 10) UNKNOWN |
| 11. Repaired | 11) '' |
| 12. Associated floors | 12) POSSIBLY (33110) (32834) (32841) |
| 13. Plastered | 13) UNKNOWN |
| 14. Wall core | 14) '' |
| 15. Types of brick (%) | 15) '' |
| 16. Composition of bricks | 16) '' |
| 17. Dimensions of bricks (sample of three) | 17) '' |

| | | |
|--|-----------------|------------------------|
| Stratigraphic Matrix | Abuts | Above |
|  | Abutted by | Below |
| | Bonded into | (34101) (32794) |
| | Contiguous with | |

| | | | |
|------------------------------------|---|-----------------|----------|
| INTERPRETATION | <u>Enclosing</u> | <u>Internal</u> | External |
| Reason for decay | NOT EXCAVATED | | |
| Indications of original dimensions | FEATURE NUMBER ASSIGNED DURING AERA | | |
| Indications of original functions | DATA CURATION PROJECT. PREVIOUSLY LUMPED | | |

TOGETHER WITH (32794).

NORTH WESTERN WALL OF MVY COURTYARD SPACE 1121 AND THE SOUTHERN WALL OF MVY SPACE 11206.

Associated contexts: **(32863)**

Context Same As: _____
Drawing Nos: **2011-82, 2012-41**

| Photographs (feature in plan, elevation, materials used, surface treatment e.g. plaster, paint etc.) | | Finds | | Samples (flotation, wet sieve, materials used e.g. bricks, stone, wood, bonding material etc.) | | | | | |
|--|-------------|-------------|--------------|--|-------------|--------|--|---------|--|
| Photograph No. | Description | Description | Artefact no. | Sample No. | Description | | | | |
| / | | / | | / | | | | | |
| | | | | | | Phase: | | Checked | Initials DCT Date 08 JAN 2013 |

(34109)

Sketch Drawings (in plan and in profile)

Remember: do not just draw the architectural feature in isolation. Show how it relates to surrounding features and include details of surface treatments, repairs/modifications/damage, bonding material(s), and associated cuts. Annotate all aspects of the feature or use a Drawing Key. Measurements must be included for all aspects of the feature and surrounding features.

Sketch Plan - Include grid co-ordinates, North arrow, and elevations.

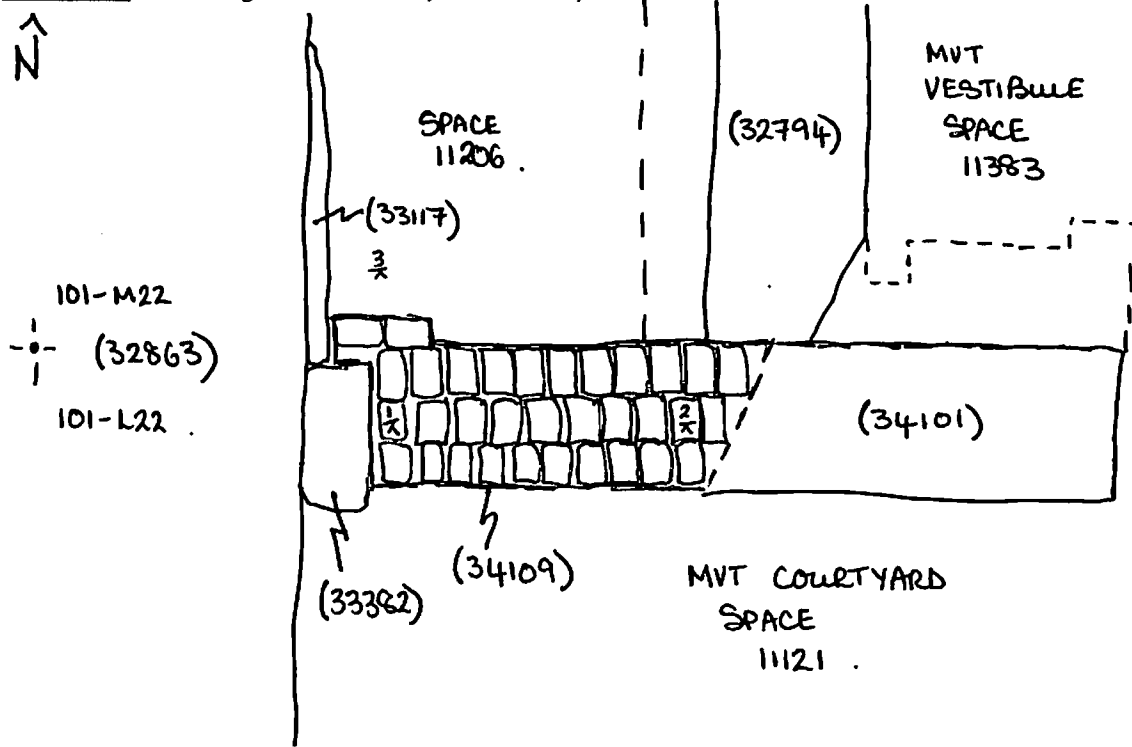

Profile Sketch

- State direction the elevation of the feature being drawn is facing e.g. 'West Facing Elevation of Feature ...'
- If feature was drawn in section then include the grid co-ordinates and elevations.

| | | | |
|------------|-------|------------|-------|
| TBM: 19.57 | | TBM: 19.75 | |
| B8: 1.57 | | B8: 1.52 | |
| IH: 21.14 | | IH: 21.27 | |
| FS | EL | FS | EL |
| 1/X 2.93 | 18.21 | 3/X 3.21 | 18.06 |
| 2/X 3.02 | 18.12 | | |