

AREA: KKT.N	GRID SQUARE (S): 201 E11	GRID CO-ORDINATES: E N	INITIALS & DATE: HAHA 25 ii 2012	FEATURE No.: 33802
-----------------------	------------------------------------	------------------------------	--	------------------------------

FEATURE TYPE (For example wall, staircase, bench, foundation structure, platform etc.): door JAMP	Full extent visible in plan: YES / (NO)
---	---

1. Dimensions (in metres)	Length: 0.40 m	Width: 0.20 m	Height: 0.06 m
2. Type of material(s) used	Mud Brick		
3. Coursing (form of construction)	one unit mud Brick		
4. Orientation	E-W		
5. Associated collapse	—		
6. Cut & fill feature #'s	—		
7. Repaired?	—		
8. Associated floors	—		
9. Surface treatments? E.g. plaster, paint, mouldings	—		
10. Size of one component	0.40 long by 0.20 width		
11. Bonding material	Sandy silt		
12. Excavated	Yes/No Not Excavated		

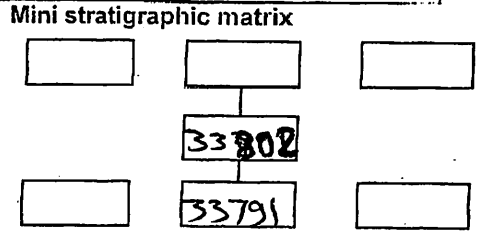

Abuts: **<33791>** Same as:

Abutted by: Associated features:

Bonded into:

Contiguous with:

Discussion and interpretation:

E-W Mud Brick door JAMP abuts <33791>
Located to the North-east to space 11324

Remember: do not just draw the architectural feature in isolation. Show how it relates to surrounding features and include details of surface treatments, repairs/modifications/damage, bonding material(s), and associated cuts. Annotate all aspects of the feature or use a Drawing Key. Measurements must be included for all aspects of the feature and surrounding features.

Sketch Plan - Include grid co-ordinates, North arrow, and elevations.

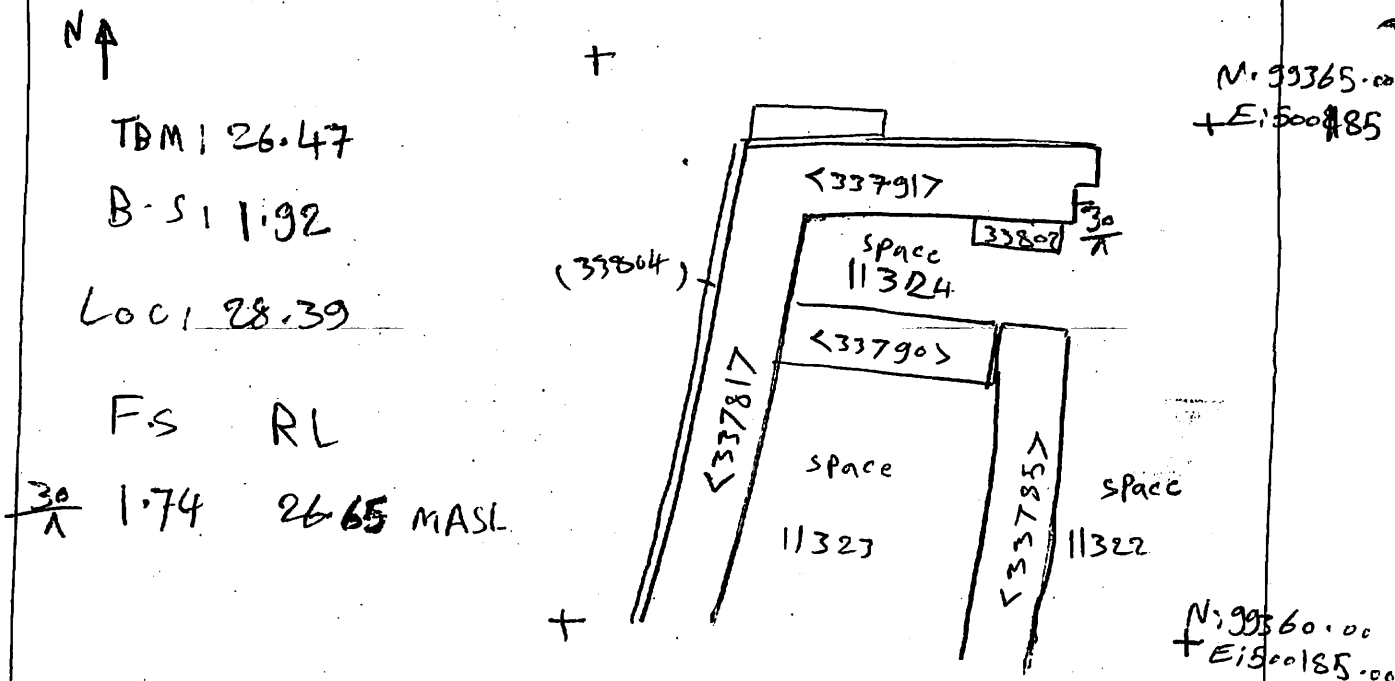

Profile Sketch - State direction the elevation of the feature being drawn is facing e.g. 'West Facing Elevation of Feature If feature was drawn in section then include the grid co-ordinates and elevations.

Drawing No.'s: 2012-4	Photo No.'s: 513113-513115-513116
Space No.: 11324	Structure No.: House A
Matrix Group:	Matrix Phase: 4b
Samples taken:	