

AREA: KKFN	GRID SQUARE (S): 201B13 201B11	GRID CO-ORDINATES: E N	INITIALS & DATE: SAER 27ii 2012	FEATURE No.: 33530									
FEATURE TYPE (For example wall, staircase, bench, foundation structure, platform etc.): wall			Full extent visible in plan: <input checked="" type="radio"/> YES / NO										
1. Dimensions (in metres)	Length: 8.00 m	Width: 1.07 m	Height: 0.02 m										
2. Type of material(s) used	mud brick												
3. Coursing (form of construction)	Four courses												
4. Orientation	E-W												
5. Associated collapse	-												
6. Cut & fill feature #'s	-												
7. Repaired?	-												
8. Associated floors	-												
9. Surface treatments? E.g. plaster, paint, mouldings	-												
10. Size of one component	0.40 m X 0.20 m												
11. Bonding material	sandy silt												
12. Excavated	Yes/No <input checked="" type="radio"/> Not excavated												
Mini stratigraphic matrix		Abuts: Same as:											
<table border="0"> <tr> <td style="border: 1px solid black; width: 40px; height: 20px;"></td> <td style="border: 1px solid black; width: 40px; height: 20px; text-align: center;">33505</td> <td style="border: 1px solid black; width: 40px; height: 20px;"></td> </tr> <tr> <td></td> <td style="border: 1px solid black; width: 40px; height: 20px; text-align: center;">33530</td> <td></td> </tr> <tr> <td style="border: 1px solid black; width: 40px; height: 20px;"></td> <td style="border: 1px solid black; width: 40px; height: 20px; text-align: center;">33509</td> <td style="border: 1px solid black; width: 40px; height: 20px;"></td> </tr> </table>			33505			33530			33509		Abutted by: Associated features:		
	33505												
	33530												
	33509												
		Bonded into:											
		Contiguous with:											
Discussion and interpretation: E-w mud brick wall located to the south of house A it consists of Four irregular courses between stretcher and header													

Remember: do not just draw the architectural feature in isolation. Show how it relates to surrounding features and include details of surface treatments, repairs/modifications/damage, bonding material(s), and associated cuts. Annotate all aspects of the feature or use a Drawing Key. Measurements must be included for all aspects of the feature and surrounding features.

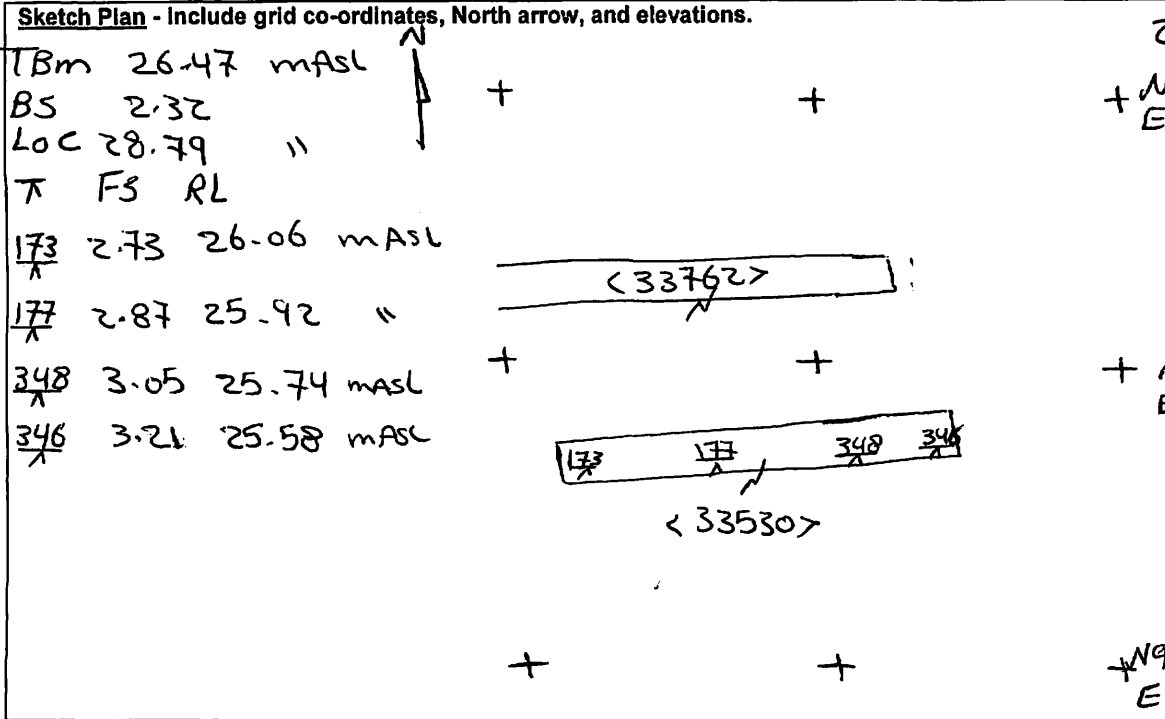

**Profile Sketch** - State direction the elevation of the feature being drawn is facing e.g. 'West Facing Elevation of Feature .... If feature was drawn in section then include the grid co-ordinates and elevations.

Drawing No.'s: 2012-4	Photo No.'s:
Space No.:	Structure No.:
Matrix Group:	Matrix Phase: 6
Samples taken:	