

AREA: MVT-E	GRID SQUARE (S): 101- K24 L24	GRID CO-ORDINATES: E N	INITIALS & DATE: JED 20-1-2011	FEATURE No.: 32785									
FEATURE TYPE (For example wall, staircase, bench, foundation structure, platform etc.): Mudbrick wall.			Full extent visible in plan: YES / (NO)										
1. Dimensions (in metres)		Length: 5.90m 4.34m.	Width: 0.44 m. (min).	Height: 0.51 m.									
2. Type of material(s) used		Mudbricks-											
3. Coursing (form of construction)		N/A											
4. Orientation N-S		N-S											
5. Associated collapse		/											
6. Cut & fill feature #'s		/											
7. Repaired?		/											
8. Associated floors		30251											
9. Surface treatments? E.g. plaster, paint, mouldings		Plaster: 32793.											
10. Size of one component		N/A											
11. Bonding material													
12. Excavated		Yes /No											
Mini stratigraphic matrix		Abuts: 30249.		Same as:									
<table border="1"> <tr> <td></td> <td>29979</td> <td>32793</td> </tr> <tr> <td></td> <td>32785</td> <td></td> </tr> <tr> <td></td> <td>NFG</td> <td></td> </tr> </table>			29979	32793		32785			NFG		Abutted by:		Associated features: 32786
	29979	32793											
	32785												
	NFG												
		Bonded into:		32793									
		Contiguous with:											
Discussion and interpretation:													
<p>N/S mb wall lined with yellow plaster. Not Excavated in the East side. Wall in relation with the E/W mbwall 32786.</p> <p>This wall is not excavated but it is possible that we have 2 different walls belonging to 2 different phases.</p>													

Remember: do not just draw the architectural feature in isolation. Show how it relates to surrounding features and include details of surface treatments, repairs/modifications/damage, bonding material(s), and associated cuts. Annotate all aspects of the feature or use a Drawing Key. Measurements must be included for all aspects of the feature and surrounding features.

Sketch Plan - Include grid co-ordinates, North arrow, and elevations.

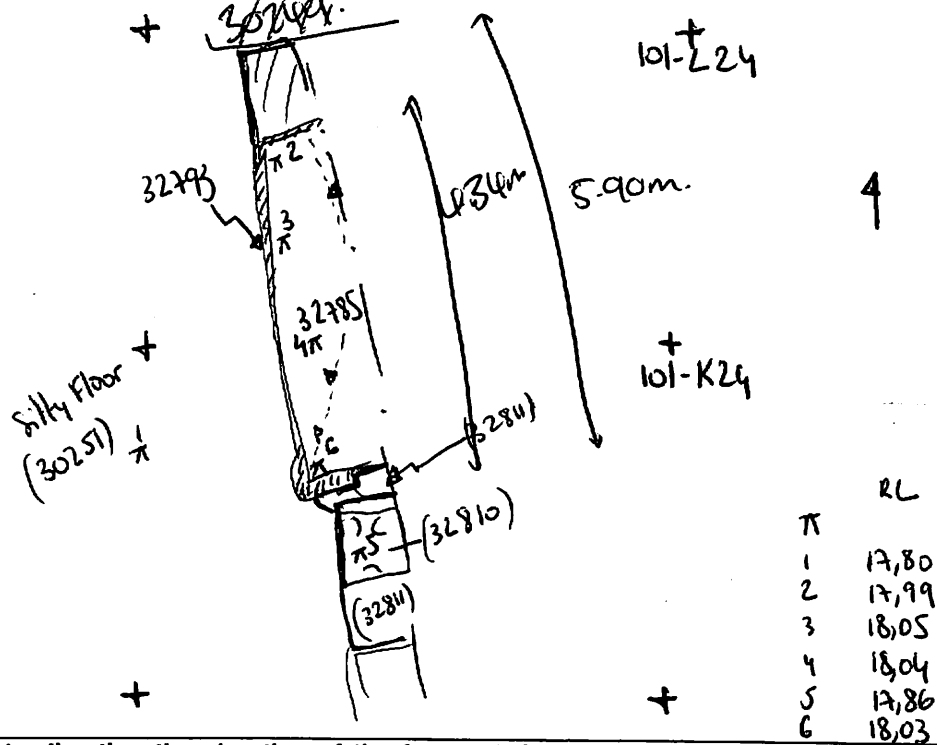

Profile Sketch - State direction the elevation of the feature being drawn is facing e.g. 'West Facing Elevation of Feature If feature was drawn in section then include the grid co-ordinates and elevations.

Drawing No.'s: 2011-81 2011-82	Photo No.'s:
Space No.:	Structure No.:
Matrix Group:	Matrix Phase:
Samples taken:	