

50

AREA: MNT-E	GRID SQUARE (S): 101-020 101-021	GRID CO-ORDINATES: E N	INITIALS & DATE: HMM 28 I 2012	FEATURE No.: <32772>
----------------	--	------------------------------	--------------------------------------	-------------------------

FEATURE TYPE (For example wall, staircase, bench, foundation structure, platform etc.): Foundation structure (limestone Core Block)	Full extent visible in plan: YES / NO <input checked="" type="checkbox"/> YES / <input type="checkbox"/> NO
--	---

1. Dimensions (in metres)	Length: 8.35 (E-W)	Width: 3.95m (N-S)	Height: 3.95m
2. Type of material(s) used	2. Limestone		
3. Coursing (form of construction)	3. Three Courses of limestone Core Block		
4. Orientation	4. E-W		
5. Associated collapse	5. NO		
6. Cut & fill feature #'s	6. —		
7. Repaired?	7. N/A		
8. Associated floors	8. —		
9. Surface treatments? E.g. plaster, paint, mouldings	9. —		
10. Size of one component *	6.14m (E-W) x 1.44m (N-S) x 1.60m height <small>6 Block - worked stone</small>		
11. Bonding material	11. —		
12. Excavated	Yes/No NO		

Mini stratigraphic matrix <div style="display: flex; justify-content: space-around; align-items: center;"> <div style="border: 1px solid black; width: 40px; height: 20px; margin: 5px;"></div> <div style="border: 1px solid black; width: 40px; height: 20px; margin: 5px;"></div> <div style="border: 1px solid black; width: 40px; height: 20px; margin: 5px;"></div> </div> <div style="text-align: center; margin: 5px 0;"> <math>\downarrow</math>  <div style="border: 1px solid black; padding: 2px; display: inline-block;">32772</div> =         </div> <div style="display: flex; justify-content: space-around; align-items: center;"> <div style="border: 1px solid black; width: 40px; height: 20px; margin: 5px;"></div> <div style="border: 1px solid black; width: 40px; height: 20px; margin: 5px;"></div> <div style="border: 1px solid black; width: 40px; height: 20px; margin: 5px;"></div> </div>	Abuts: Same as: <29804>
	Abutted by: Associated features:
	Bonded into:
	Contiguous with:

Discussion and interpretation:

- Three Courses of limestone Core Block, limestone foundation dates to Menkaure Time. The Three Courses only visible in NE Corner of the temple.

Block \* 3.30m (E-W) x 2.88m (N-S) x 1.10m height (Roughly hwen)  
 - Some of this stones are nicely worked and some are roughly hwen.

UPPER ELEVATION: TOP COURSE = 19.73m ASL.  
 2ND COURSE = 17.88m ASL.  
 3RD COURSE = 17.70m ASL.

→ FOUNDING LEVEL NOT REACHED.

4.

REACHED.

Remember: do not just draw the architectural feature in isolation. Show how it relates to surrounding features and include details of surface treatments, repairs/modifications/damage, bonding material(s), and associated cuts. Annotate all aspects of the feature or use a Drawing Key. Measurements must be included for all aspects of the feature and surrounding features.

Sketch Plan - Include grid co-ordinates, North arrow, and elevations.

TBM 19.75  
BS 0.63  
Loc 20.38



TK	E	RI
1	0.76	19.62
2	0.65	19.73
3	0.58	19.80
4	0.70	19.68
5	0.62	19.56
6	0.88	19.50
7	0.83	19.55
8	2.50	17.88
9	2.54	17.84
10	2.57	17.81
11	2.60	17.78
12	3.63	17.20

BS0-08

13

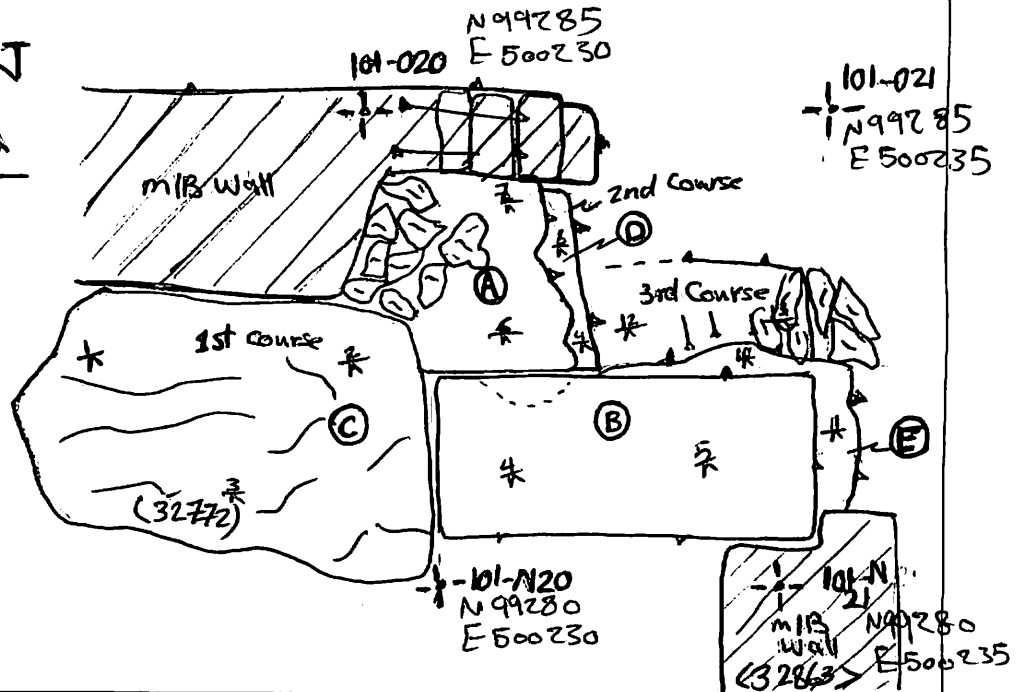

Profile Sketch - State direction the elevation of the feature being drawn is facing e.g. 'West Facing Elevation of Feature .... If feature was drawn in section then include the grid co-ordinates and elevations.

southern facing section for 1. m Core Block  
in Trench G

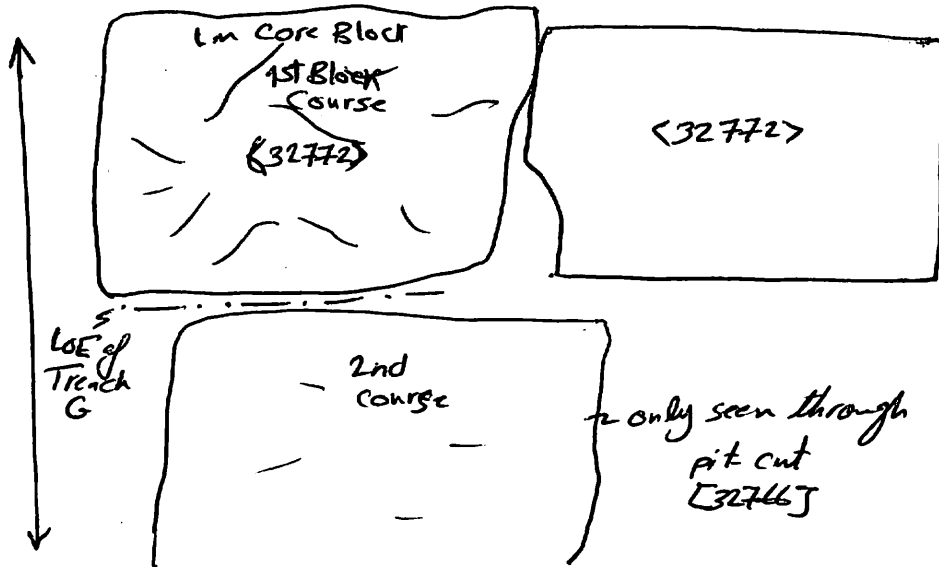

Drawing No.'s: 2012-22	Photo No.'s: pre-ex.
Space No.: FOUNDATION FOR UTILE TEMPLE - RECORD IN SLICE 11202.	Structure No.: 15169.
Matrix Group:	Matrix Phase:
Samples taken: N/A.	