

50

AREA: MNT-E	GRID SQUARE (S): 10I-N20 10I-N21	GRID CO-ORDINATES: E N	INITIALS & DATE: HMM, AZZ 28 I 2012	FEATURE No.: <32765>
----------------	--	------------------------------	---	-------------------------

FEATURE TYPE (For example wall, staircase, bench, foundation structure, platform etc.): wall	Full extent visible in plan: YES / NO <input checked="" type="checkbox"/> YES / <input type="checkbox"/> NO
--	---

1. Dimensions (in metres)	Length: 6.35m	Width: 0.90m	Height: 1.47m
2. Type of material(s) used	2. mud Brick (Nile clay)		
3. Coursing (form of construction)	3. 12 Courses stretcher course header course stretcher course header course stretcher course header course stretcher course header course stretcher course header course stretcher course header course		
4. Orientation	4. E-W		
5. Associated collapse	5. (32767)		
6. Cut & fill feature #'s	6. —		
7. Repaired?	7. N-A		
8. Associated floors	8. —		
9. Surface treatments? E.g. plaster, paint, mouldings	9. —		
10. Size of one component	10. 0.40m x 0.18m x 0.14m		
11. Bonding material	light grey sandy silt, med limestone frag, occa pottery		
12. Excavated	Yes/No <input checked="" type="checkbox"/> Yes / <input type="checkbox"/> No		

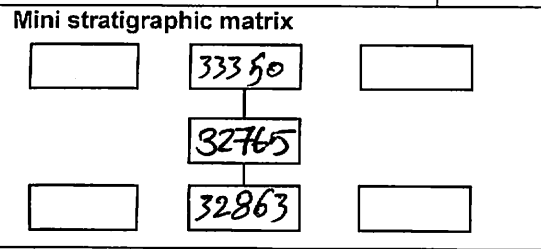

Abuts: <32863>
to E

Same as:

Abutted by:

Bonded into: STRUCTURE 15169

Contiguous with:

Discussion and interpretation:

E-W mud Brick Wall formed the southern limit of space (411) = (11202), Badly eroded wall. # in very bad condition. the Brick are very crumbly it is hard to define the Courses of this wall because it is badly, but it seems from the north facing section the 3 first courses header, 4th stretcher, 5th, 6th stretcher, 7th header 8th stretcher, 9th header, 10, 11, 12 stretchers.

Handwritten mark

Remember: do not just draw the architectural feature in isolation. Show how it relates to surrounding features and include details of surface treatments, repairs/modifications/damage, bonding material(s), and associated cuts. Annotate all aspects of the feature or use a Drawing Key. Measurements must be included for all aspects of the feature and surrounding features.

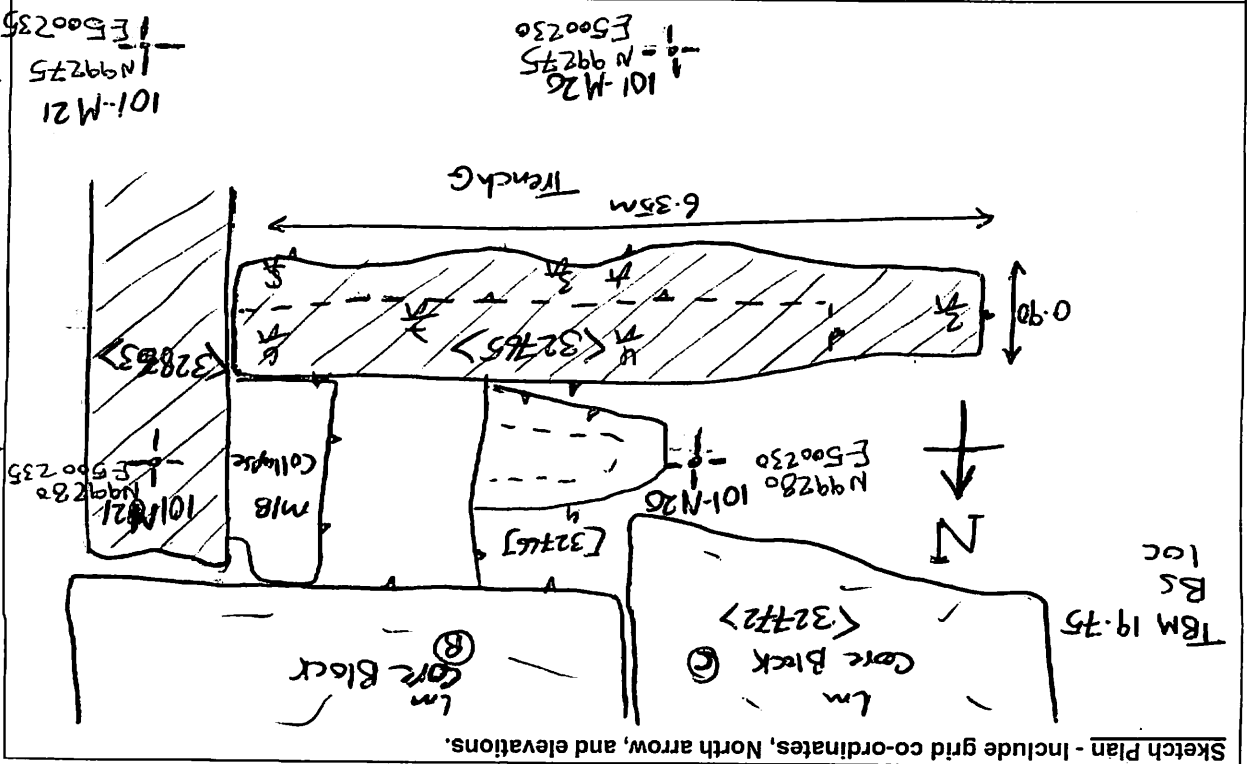

Profile Sketch - State direction the elevation of the feature being drawn is facing e.g. 'West Facing' Elevation of Feature If feature was drawn in section then include the grid co-ordinates and elevations.

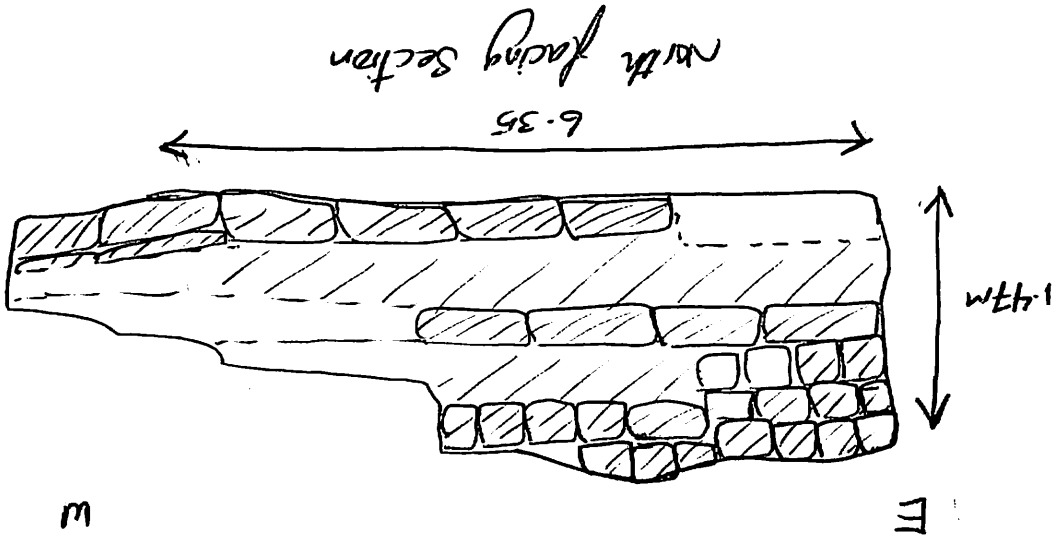

Drawing No.'s: 2012-22, 2012-23, 2012-24, 2012-25, 2012-26, 2012-27, 2012-28, 2012-29, 2012-30, 2012-31, 2012-32, 2012-33, 2012-34, 2012-35, 2012-36, 2012-37, 2012-38, 2012-39, 2012-40, 2012-41, 2012-42, 2012-43, 2012-44, 2012-45	Photo No.'s: 512441, 42, 43, 44, 45	Space No.: (11202)	Matrix Group:	Matrix Phase:	Samples taken:
---	-------------------------------------	--------------------	---------------	---------------	----------------