

6
9

Site: GPMP Area: KKT-N	GRID SQUARE(S) 201E22	ARCHITECTURE	FEATURE 31147
1. Material	1. mud BRICK		
2. Size of materials	2. 400mm x 180mm x 30mm		
3. Finish	3. —		
4. Coursing/bond	4. one course of ^{headers} stretcher mud brick / Blocking		
5. Form	the entrance between the (31101) and (31103)		
6. Direction of faces	5. Blocking		
7. Orientation	6. E-W		
8. Dimensions	7. N-S		
9. Associated collapse	8. 0.53m (N-S) x 0.40m (E-W) x 0.04m depth		
10. Founds, cuts & fills	9. — 10. — 11. —		
11. Repaired	12. —		
12. Associated floors	13. No 14. No		
13. Plastered	15. Nile Brick 100%		
14. Wall core	16. Nile clay brick dark black clay, freq is small limestone		
15. Types of brick (%)	17. 400mm x 180mm x 30mm		
16. Composition of bricks			
17. Dimensions of bricks (sample of three)			

Stratigraphic Matrix	Abuts	Above
<input type="checkbox"/>	Abutted by	Below
<input type="checkbox"/>	Bonded into	
<input type="checkbox"/>	Contiguous with	

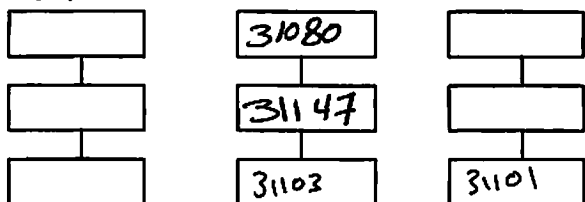

INTERPRETATION	Enclosing	Internal	External
Reason for decay	Light Brown MIB Blocking the doorway between		
Indications of original dimensions	the E-W MIB wall (31101) and the MIB		
Indications of original functions	N-S wall (31103), this blocking is		
very shallow just one course about 4cm depth Blocking			
between Room 74D and 74C			

Associated contexts:

Context Same As:

Drawing Nos: 31147

Photographs (feature in plan, elevation, materials used, surface treatment e.g. plaster, paint etc.)		Finds		Samples (flotation, wet sieve, materials used e.g. bricks, stone, wood, bonding material etc.)	
Photograph No.	Description	Bag No.	Description	Bag No.	Description
306142					
306143					
		Phase:	6	Checked	Initials HMM Date 18 ii 09

Sketch Drawings (in plan and in profile)

Remember: do not just draw the architectural feature in isolation. Show how it relates to surrounding features and include details of surface treatments, repairs/modifications/damage, bonding material(s), and associated cuts. Annotate all aspects of the feature or use a Drawing Key. Measurements must be included for all aspects of the feature and surrounding features.

Sketch Plan - Include grid co-ordinates, North arrow, and elevations.

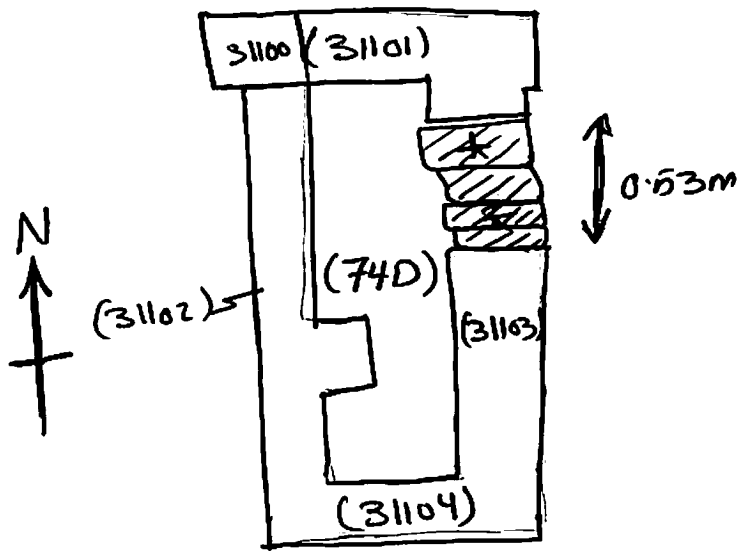

TBM 23.23
BS 1.41
IH 24.64

7 23.28
7 23.25

Profile Sketch

- State direction the elevation of the feature being drawn is facing e.g. 'West Facing Elevation of Feature
- If feature was drawn in section then include the grid co-ordinates and elevations.

