

AREA: KKT-E+	GRID SQUARES: 201-H46	INITIALS & DATE: DCS 15 APRIL 2014	FEATURE No.: 34601
FEATURE TYPE (For example wall, staircase, bench, foundation structure, platform etc.): BLOCKING.		Full extent visible in plan: YES / <input checked="" type="radio"/> NO	
1. Dimensions (in metres)	Length: 0.40m	Width: 0.12m.	Height: 0.09m
2. Type of material(s) used	SANDY CLAY, POTTERY FRAGS		
3. Coursing (form of construction)	MIXED MATERIAL. MARL BRICKS WERE PLANNED OVER THIS FEATURE IN 2012 WHICH WERE NOT VISIBLE IN 2014.		
4. Orientation	/		
5. Associated collapse	POSSIBLY (33255)		
6. Cut & fill feature #'s	CUT UNKNOWN		
7. Repaired?	UNKNOWN		
8. Associated floors	(33814)		
9. Surface treatments? E.g. plaster, paint, mouldings	NONE.		
10. Size of one component	/		
11. Bonding material	NONE		
12. Excavated	Yes <input checked="" type="radio"/> No		
Mini stratigraphic matrix 		Abuts:	Same as:
		Abutted by:	Associated features:
		Bonded into:	
		Contiguous with:	
Discussion and interpretation: BLOCKING OF AN OPENING IN WALL OF SILO (33437). COMPARE WITH BLOCKING (34546) OF OPENING IN WALL OF SILO (33438).			

Remember: do not just draw the architectural feature in isolation. Show how it relates to surrounding features and include details of surface treatments, repairs/modifications/damage, bonding material(s), and associated cuts. Annotate all aspects of the feature or use a Drawing Key. Measurements must be included for all aspects of the feature and surrounding features.

Sketch Plan - Include square numbers, North arrow, space numbers, and elevations.

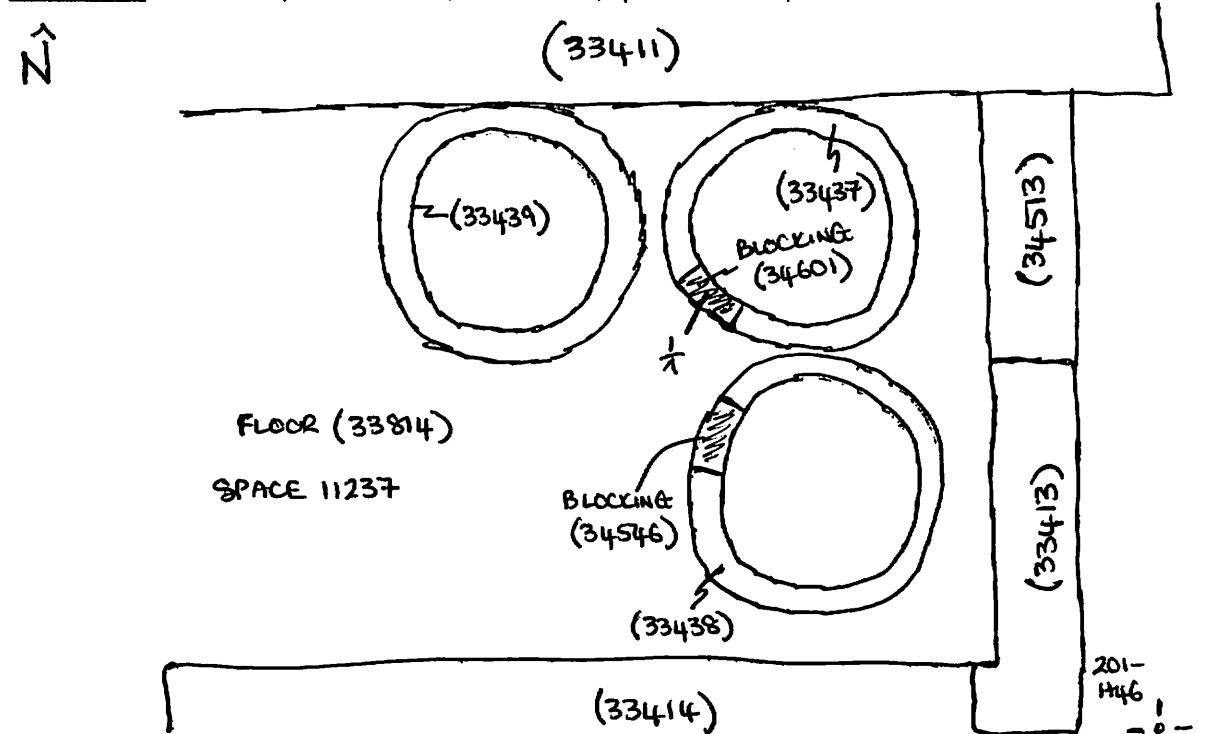

Profile Sketch - State direction the elevation of the feature being drawn is facing e.g. 'West Facing Elevation of Feature If feature was drawn in section then include the grid co-ordinates and elevations.

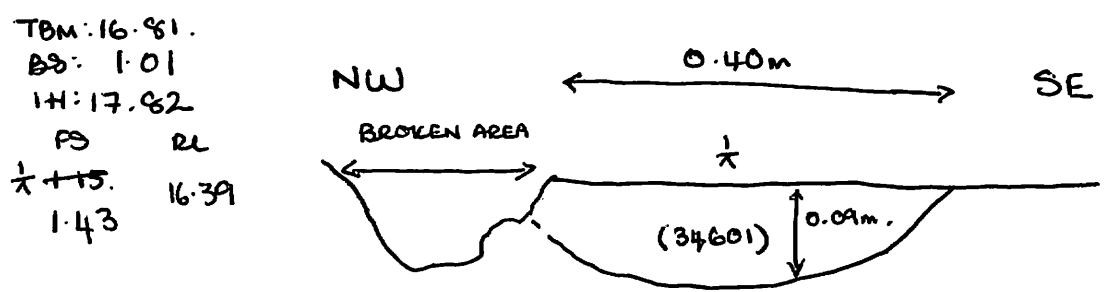

Drawing No.'s:	2014-35	Photo No.'s:	815364, 815365, 815366 815367, 815368
Space No.:	11237	Structure No.:	1524
Matrix Group:		Matrix Phase:	
Samples taken:		Sondage No.:	183