

AREA: KKT-E+	GRID SQUARES: 201-G45	INITIALS & DATE: DCJ 11 FEB 2014	FEATURE No.: 34455
FEATURE TYPE (For example wall, staircase, bench, foundation structure, platform etc.): CORE		Full extent visible in plan: <input checked="" type="radio"/> YES / NO	
1. Dimensions (in metres)	Length: 1.09m	Width: 0.21m	Height: 0.16m
2. Type of material(s) used	MARL BRICKS & SILT		
3. Coursing (form of construction)	ON THE WESTERN SIDE WAS A SINGLE ROW OF MARL BRICKS - 2 STRETCHERS & 4 HALF BRICKS		
4. Orientation	NW   SE		
5. Associated collapse	NONE		
6. Cut & fill feature #'s	NONE [34462]		
7. Repaired?	UNKNOWN BUT APPEARED NOT.		
8. Associated floors	(33284)		
9. Surface treatments? E.g. plaster, paint, mouldings	WHITE WASH (34456)		
10. Size of one component	MARL BRICK (WHOLE) 0.26m (L) x 0.15m (W) MARL BRICK (HALF) 0.15m (W) x 0.16m (L)		
11. Bonding material	NONE		
12. Excavated	<input checked="" type="radio"/> Yes / No 100%		
Mini stratigraphic matrix		Abuts:	Same as:
<input type="checkbox"/>	34456	<input type="checkbox"/>	
	34455		
<input type="checkbox"/>	33994	<input type="checkbox"/>	
		Abutted by:	Associated features: (33994)
		Bonded into:	
		Contiguous with:	(34456)
Discussion and interpretation:			
<p>CORE OF MUD BRICK BENCH (33994)</p> <p>COMPRISED A SINGLE ROW OF MARL BRICKS AND A SILT DOMINATED MATERIAL. THIS MATERIAL WAS MIXED WITH MARL BRICK FRAGMENTS (FREQ), OCC LIMESTONE CHIPS, VERY OCC SMALL POTTERY FRAGMENTS &amp; CHARCOAL.</p> <p>100% SAMPLED FOR FLOTATION</p> <p>VOLUME : 45 LITRES</p>			

(34455)

AERA 2014

ARCHITECTURE RECORDING FORM

Remember: do not just draw the architectural feature in isolation. Show how it relates to surrounding features and include details of surface treatments, repairs/modifications/damage, bonding material(s), and associated cuts. Annotate all aspects of the feature or use a Drawing Key. Measurements must be included for all aspects of the feature and surrounding features.

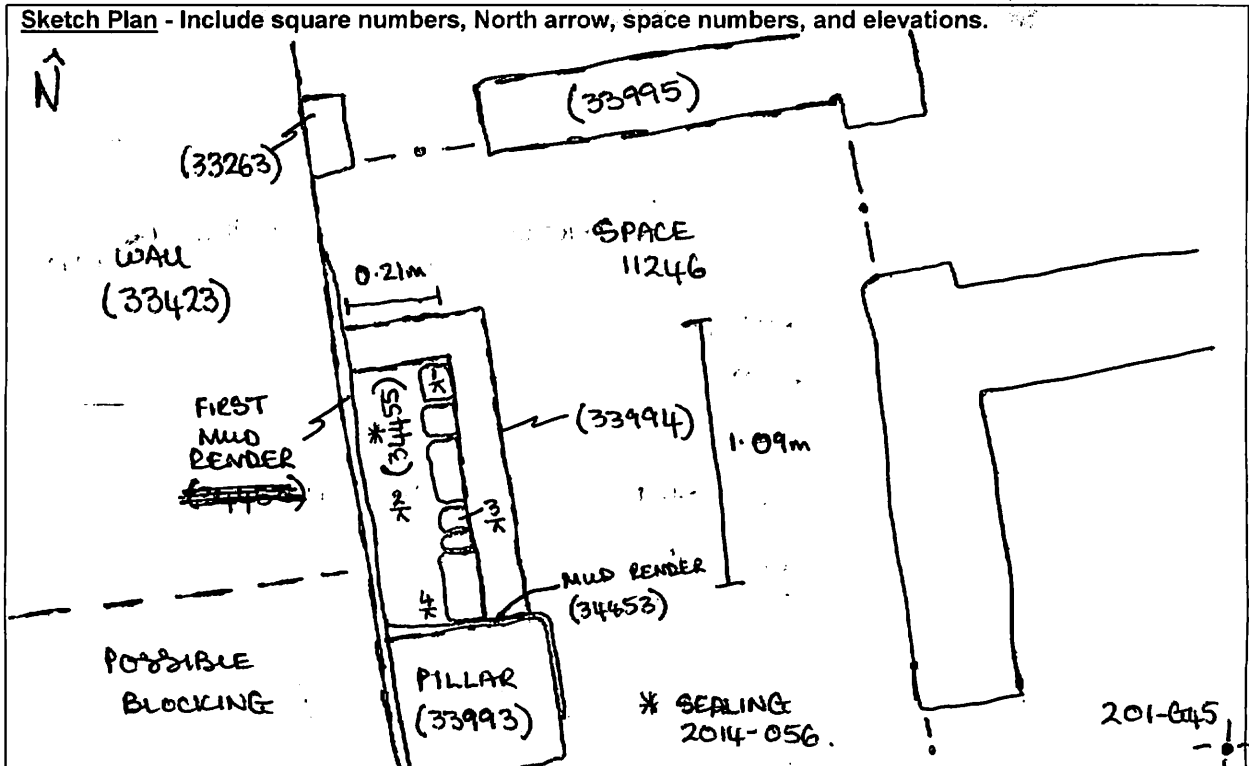

Profile Sketch - State direction the elevation of the feature being drawn is facing e.g. 'West Facing Elevation of Feature .... If feature was drawn in section then include the grid co-ordinates and elevations.

TBM: 16.81  
BS: 0.87  
IH: 17.68

FS	RL
1/1.73	15.985
2/1.75	15.93
3/1.76	15.92
4/1.74	15.94

2014-056 POSSIBLE SEALING.

2014-057, 058, 059, 060, 061, 062, 063, FLOTATION.  
064, 065.

Drawing No.'s: 2014-34455 ✓	Photo No.'s: 513804, 513805
Space No.: 11246	Structure No.: 15124
Matrix Group: 18226	Matrix Phase:
Samples taken: SEE ABOVE PLOT #s	Sondage No.: 182.