

GPMP GIZA

Site: SAPS 2 / LTM Area: KKT-N.		GRID SQUARE(S) 201-E21	ARCHITECTURE	FEATURE 34383
1. Material	1) MIXED MATERIAL - DESCRIBED ON FEATURE FORM FOR REPAIR WALL (31100) AS: " 0.90m X 0.23m OF MID-			
2. Size of materials	2) SEE #1. BROWNISH GREY SILTY SAND			
3. Finish	3) IRREGULAR WITH OCCASIONAL LIMESTONE			
4. Coursing/bond	4) UNKNOWN FRAGS 10-20mm AND OCCASIONAL			
5. Form	5) WALL CORE. CERAMIC PIECES C. 10mm "			
6. Direction of faces	6) N/A.			
7. Orientation	7) NE/SW			
8. Dimensions	8) 0.97m (L) X 0.24m (W).			
9. Associated collapse	9) UNKNOWN.			
10. Founds, cuts & fills	10) "			
11. Repaired	11) "			
12. Associated floors	12) "			
13. Plastered	13) N/A			
14. Wall core	14) N/A			
15. Types of brick (%)	15) UNKNOWN			
16. Composition of bricks (sample of three)	16) "			
Stratigraphic Matrix		Abuts		Above
		Abutted by		Below
		Bonded into		
		Contiguous with		
INTERPRETATION		Enclosing		Internal
Reason for decay		CORE OF REPAIR WALL (31100) EXCAVATED		
Indications of original dimensions		IN 2009 AS PART OF (31100) ALTHOUGH		
Indications of original functions		RECOGNISED AS A SEPARATE FEATURE.		
SPACE: 11577, 11580				
STRUCTURE: 15112.				
Associated contexts: (31100).				
Context Same As:				
Drawing Nos: 2009-31100				
Photographs (feature in plan, elevation, materials used, surface treatment e.g. plaster, paint etc.)		Finds		Samples (flotation, wet sieve, materials used e.g. bricks, stone, wood, bonding material etc.)
Photograph No.	Description	Description	Artefact no.	Sample No. Description
		Phase:		Checked
				Initials DCJ Date 27 APRIL 2013.

34383 .

201-E21 1

Sketch Drawings (in plan and in profile)

Remember: do not just draw the architectural feature in isolation. Show how it relates to surrounding features and include details of surface treatments, repairs/modifications/damage, bonding material(s), and associated cuts. Annotate all aspects of the feature or use a Drawing Key. Measurements must be included for all aspects of the feature and surrounding features.

Sketch Plan - Include grid co-ordinates, North arrow, and elevations.

NOT TO SCALE N ↑

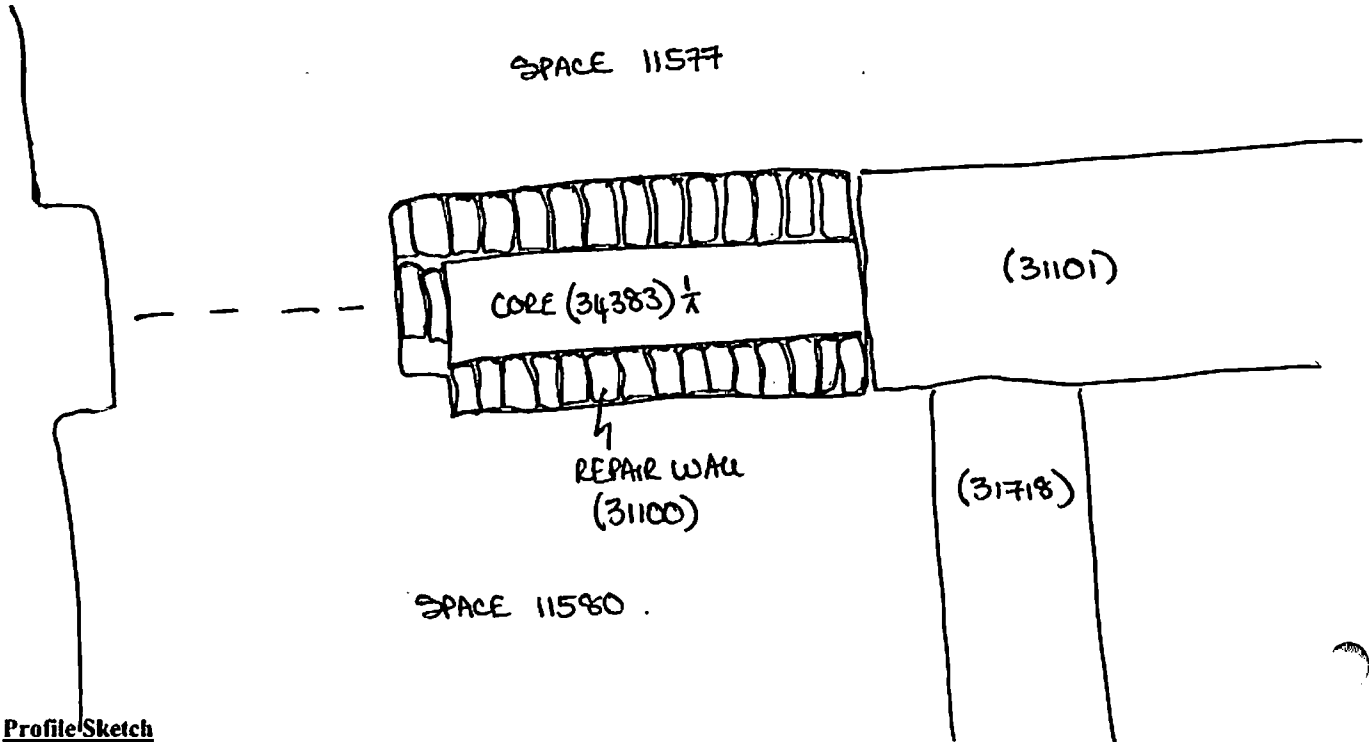

Profile Sketch

- State direction the elevation of the feature being drawn is facing e.g. 'West Facing Elevation of Feature
- If feature was drawn in section then include the grid co-ordinates and elevations.

TBM: 23.23

BB: 1.97

IH: 25.20

FS

RL

1/2 1.73

23.47.