

GPMP GIZA

Site: SAFS2/ETM Area: KKT-N	GRID SQUARE(S) 201-D22	ARCHITECTURE	FEATURE 34380
1. Material	1) MUDBRICK		
2. Size of materials	2) 0.21m (L) X 0.10m (W) . FROM PLAN		
3. Finish	3) REGULAR		
4. Coursing/bond	4) ONE ROW OF HEADERS		
5. Form	5) WALL REPAIR		
6. Direction of faces	6) NW, NE, SE		
7. Orientation	7) NE/SW .		
8. Dimensions	8) 1.10m (L) X 0.61m (W) .		
9. Associated collapse	9) UNKNOWN		
10. Founds, cuts & fills	10) "		
11. Repaired	11) "		
12. Associated floors	12) "		
13. Plastered	13) (31150) (31151) .		
14. Wall core	14) MPP (34379) .		
15. Types of brick (%)	15) ONE TYPE		
16. Composition of bricks	16) SMALL BROWN BUENT BRICKS .		
17. Dimensions of bricks (sample of three)	17) SEE # 2 .		
Stratigraphic Matrix			Abuts Above Abutted by Below Bonded into Contiguous with
INTERPRETATION	Enclosing Internal External		
Reason for decay			
Indications of original dimensions	REPAIR TO WALL (31104)		
Indications of original functions	EXCAVATED IN 2009 AS (31148) AS THIS SECTION IS ON A DIFFERENT ALIGNMENT IT WAS ASSIGNED A SEPARATE FEATURE NUMBER DURING THE DATA CURATION PROJECT.		
SPACE:	11574, 11575, 11576		
STRUCTURE:	1512		
Associated contexts:			
Context Same As:			
Drawing Nos:	2009 - 31148		
Photographs (feature in plan, elevation, materials used, surface treatment e.g. plaster, paint etc.)	Finds		Samples (flotation, wet sieve, materials used e.g. bricks, stone, wood, bonding material etc.)
Photograph No. Description	Description	Artefact no.	Sample No. Description
		Phase:	Checked
		Initials DCS Date 25 APRIL 2013 .	

34380

Sketch Drawings (in plan and in profile)

Remember: do not just draw the architectural feature in isolation. Show how it relates to surrounding features and include details of surface treatments, repairs/modifications/damage, bonding material(s), and associated cuts. Annotate all aspects of the feature or use a Drawing Key. Measurements must be included for all aspects of the feature and surrounding features.

Sketch Plan - Include grid co-ordinates, North arrow, and elevations.

NOT TO SCALE \uparrow N

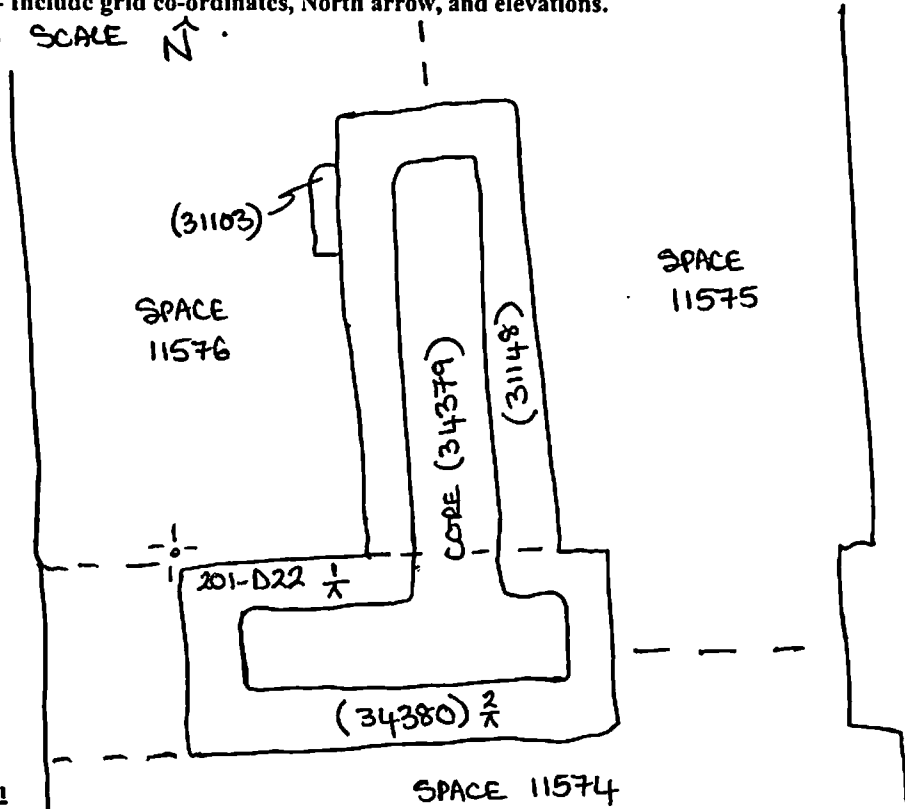

Profile Sketch

- State direction the elevation of the feature being drawn is facing e.g. 'West Facing Elevation of Feature ...'
- If feature was drawn in section then include the grid co-ordinates and elevations.

TBM: 23.23

BS: 1.41

IH: 24.64

FS	EL
$\frac{1}{x}$ 1.51	23.13

$\frac{2}{x}$ 1.59	23.05
--------------------	-------