

| | | | |
|--|--|---------------------|-------------------------|
| GPMP 2008 | GRID SQUARE(S) 101-T29/T28. | ARCHITECTURE | CONTEXT 29432 |
| 1. Material | 1. Mudbrick | | |
| 2. Size of materials | 2. - - - - - 3. - - - | | |
| 3. Finish | 3. 2 courses regular | | |
| 4. Coursing/bond | 4. 5 wall. | | |
| 5. Form | 5. N-S. and E-W. | | |
| 6. Direction of faces | 6. E-W. | | |
| 7. Orientation | 7. 2.95 m length - 0.88 m. wide. | | |
| 8. Dimensions | 8. N/A. | | |
| 9. Associated collapse | 9. Cut by [29443] and [29444]. | | |
| 10. Finds, cuts & fills | 10. N/A. | | |
| 11. Repaired | 11. Probably [29446] | | |
| 12. Associated floors | 12. On the N. face [29442] [29476] and [29445] | | |
| 13. Plastered | and Wand N faces [29475] | | |
| 14. Wall core | 13. Bubblegum bricks and sandy silt brick (40-60%) | | |
| 15. Types of brick (%) | 14. Clay silt and sand. | | |
| 16. Composition of bricks | 15. 40 x 18 cm; 42 x 20 cm; 28 x 10 cm. | | |
| 17. Dimensions of bricks (sample of three) | | | |

Stratigraphic Matrix

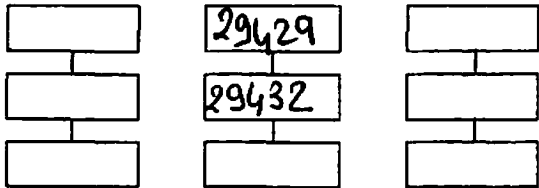

Abuts Above
 Abutted by [29429] Below
 Bonded into
 Contiguous with [29449]

INTERPRETATION

Enclosing Internal External

Reason for decay: E-W mudbrick wall.
 Indications of original dimensions: 3 layers of plaster in N face and 1 layer on faces W and S.
 Indications of original functions: It is cut by [29443] and [29444] in the N. part. Between this wall and the wall [21921] we have a passage with a marl plaster floor [29442]. Wall which have a descamb [29449] in the S. face. Works probably with walls [21887] and [21886] in the same time.
 Associated contexts: 21921, 29440, 29449, 29475, 29442, 29445, 29476, 29562, 29439, 21922, 30104

Context Same As: [21921]

Drawing Nos: 2008. 38. ; 2008-110

Samples

| | | |
|---|-----------------------|-------------------------------------|
| Photographs 510920 to 510924 510961 - Roll 510962 | Finds Bag No. Type | |
| Frames | | Building Complex: |
| B-W | | Phase |
| CS | | |
| DP | | |
| CP | Site Book Pages | Checked Initials DEW Date 31-III-08 |

At the S., it works with walls [29562] and [21922] to create a door (cf [29449] and [29439]) and a space, probably a room with a marl plaster floor.

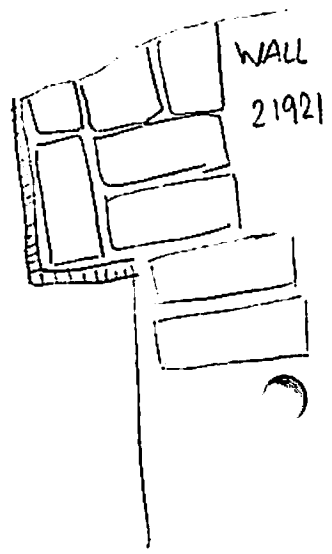
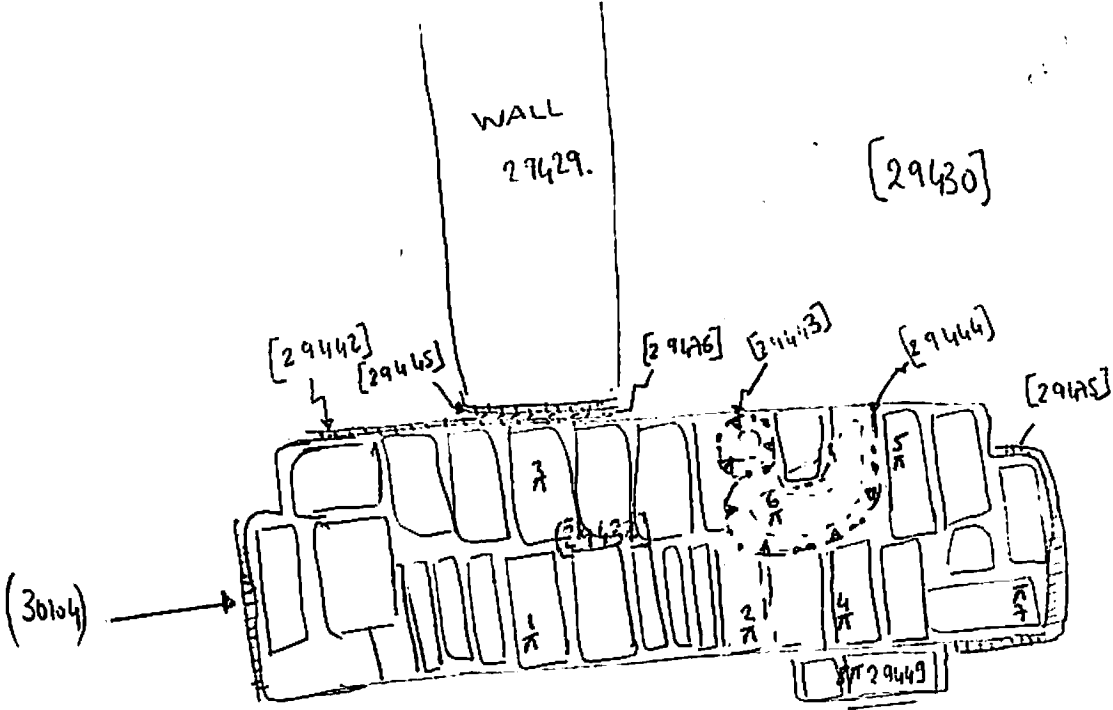
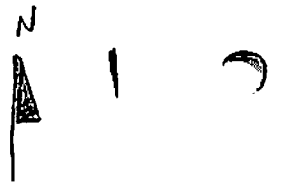

TBM 18,54 BS : 1,63 CH : 20,17

| | | |
|----|------|-------|
| π1 | 2,15 | 18,02 |
| π2 | 2,23 | 17,94 |
| π3 | 2,11 | 18,06 |
| π4 | 2,21 | 17,96 |
| π5 | 2,19 | 17,98 |
| π6 | 2,27 | 17,90 |
| π7 | 2,22 | 17,95 |