

GIZA PLATEAU MAPPING PROJECT

Grid Square(s) 201-G29	Area KKT	Context Type CUT	Central Coords	Context 27916																																	
DEPOSIT			CUT																																		
1. Compaction 2. Colour 3. Composition/Particle Size (Over 10%) 4. Inclusions (Under 10%) 5. Thickness and extent 6. Top and bottom boundaries 7. Other comments 8. Method and conditions	1/ SQUARE		1. Shape in plan																																		
	2/ ROUNDED		2. Corners																																		
	3/ 1.30m N-S; 0.120m E-W		3. Dimension/Depth																																		
	4/ SHARP		4. Break of slope-top																																		
	5/ STOPPED THAN VERTICAL		5. Sides																																		
	6/ SHARP		6. Break of slope-base																																		
	7/ DEEPER AT SOUTH + WEST		7. Base																																		
	8/ E-W		8. Orientation																																		
	9/ -		9. Inclination of axis																																		
	10/ -		10. Truncated (if known)																																		
	11/ 27915, 27921 PRIMARY FILL		11. Fill #s																																		
	12/ INLET AT NORTH SIDE		12. Other comments Draw profile overleaf																																		
Type of feature:																																					
Stratigraphic Matrix																																					
<table style="width: 100%; border-collapse: collapse;"> <tr> <td style="border: 1px solid black; width: 20px; height: 20px;"></td> <td style="border: 1px solid black; width: 20px; height: 20px;"></td> <td style="border: 1px solid black; width: 20px; height: 20px;"></td> <td style="border: 1px solid black; width: 20px; height: 20px; text-align: center;">27921</td> <td style="border: 1px solid black; width: 20px; height: 20px;"></td> <td style="border: 1px solid black; width: 20px; height: 20px;"></td> <td style="border: 1px solid black; width: 20px; height: 20px;"></td> <td style="border: 1px solid black; width: 20px; height: 20px;"></td> <td style="border: 1px solid black; width: 20px; height: 20px;"></td> <td style="border: 1px solid black; width: 20px; height: 20px;"></td> <td style="border: 1px solid black; width: 20px; height: 20px;"></td> </tr> <tr> <td colspan="3" style="text-align: center;">This context is</td> <td style="border: 1px solid black; width: 20px; height: 20px; text-align: center;">27916</td> <td colspan="7"></td> </tr> <tr> <td style="border: 1px solid black; width: 20px; height: 20px;"></td> <td style="border: 1px solid black; width: 20px; height: 20px;"></td> <td style="border: 1px solid black; width: 20px; height: 20px;"></td> <td style="border: 1px solid black; width: 20px; height: 20px; text-align: center;">27903</td> <td style="border: 1px solid black; width: 20px; height: 20px; text-align: center;">27914</td> <td style="border: 1px solid black; width: 20px; height: 20px;"></td> <td style="border: 1px solid black; width: 20px; height: 20px;"></td> <td style="border: 1px solid black; width: 20px; height: 20px;"></td> <td style="border: 1px solid black; width: 20px; height: 20px;"></td> <td style="border: 1px solid black; width: 20px; height: 20px;"></td> <td style="border: 1px solid black; width: 20px; height: 20px;"></td> </tr> </table>								27921								This context is			27916											27903	27914						
			27921																																		
This context is			27916																																		
			27903	27914																																	
Your interpretation:	Internal	External	Structural	Other (specify)																																	
Your discussion:																																					
<p>PIT CONNECTED TO [27918] BY INLET POSSIBLY FOR PROCESSING SOMETHING THAT REQUIRES WATER</p> <p>THE PRIMARY FILL CONTAINED SOME METALLIC STILL ARTICULATED TO 2nd + 3rd TANKS TO MUST HAVE GONE IN FIRST.</p>																																					
				Placement in square																																	
Context same as:			See contexts: 27915, 27921, 27917, 27918																																		
Site Book Refs:			Matrix phase: (5)																																		
			Initials and date LMY 15-11-07																																		
Checked Interpretation:																																					
Provisional period			Group/Phase																																		
			Initials and date																																		

Context Number 27916 GPMP 2007

Bag Numbers

Ceramics	Objects
Environmental Samples & Type	Exotics
Charcoal	
	Other
Bones	
Lithics	

Photographs 305770-4
+ 305776-78

Drawings

Plans ~~2007-181~~ 2007-181 Sections

Top Elevation 21.06 Bottom Elevations 21.44

Sketch Plan

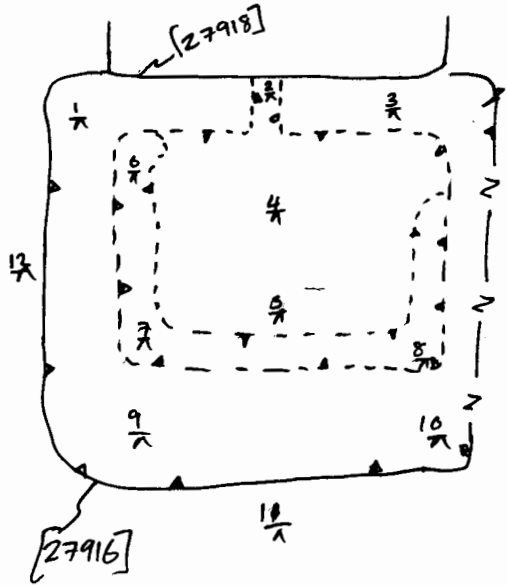

TBM	21.38	
BS	1.00	
14	22.38	
	FS	RL
1	0.98	21.40
2	1.16	21.18
3	0.99	21.39
4	1.17	21.17
5	1.19	21.15
6	1.26	21.08
7	1.28	21.06
8	1.27	21.07
9	1.00	21.38
10	1.03	21.35
11	0.94	21.44